

99841 SKF

Wear sleeves

TYPE: Wear sleeves, SKF Speedi-Sleeve, Speedi-Sleeve Gold, for heavy industrial applications (SKF)

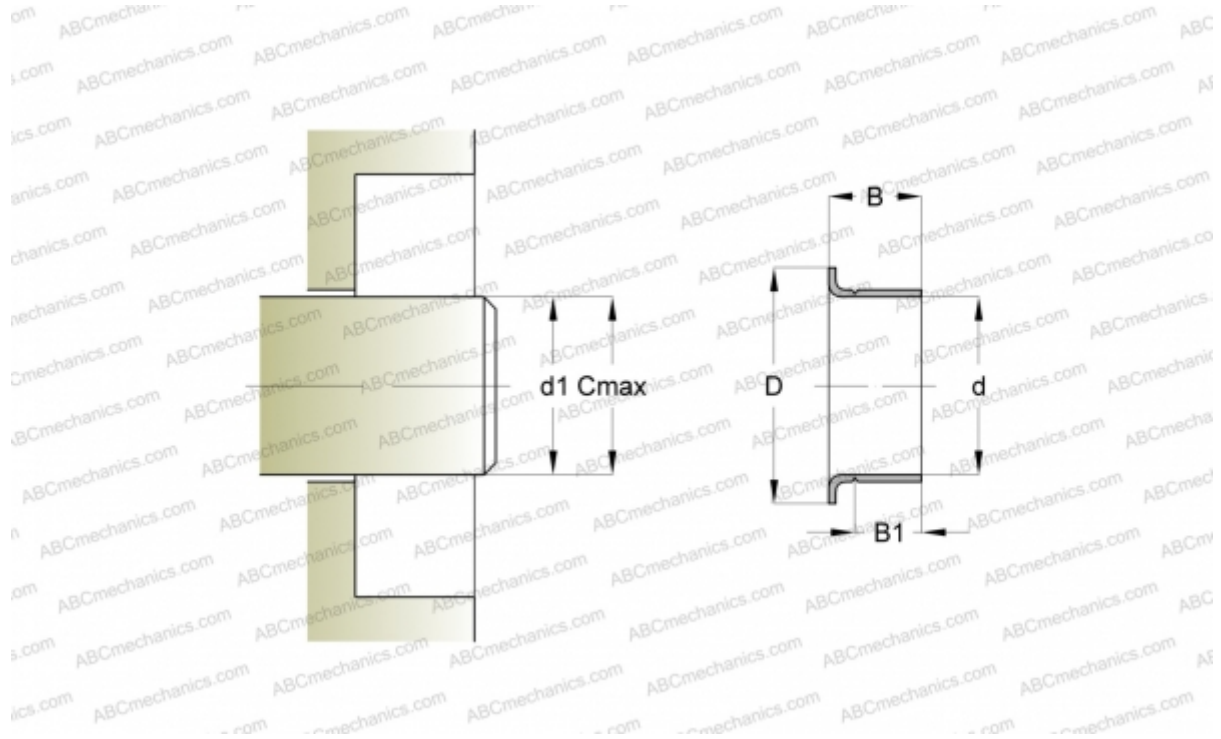

Technical specification

DIMENSIONS, MM

d_1	64,920
d	65,000
D	72,390
B	22,990
B_1	19,990
C	65,070

MANUFACTURER

[SKF](#)

INTERCHANGE

CR	CR 99841
----	--------------------------

CALCULATION DATA

Maximum shaft surface speed	0,001 m/s
-----------------------------	-----------