

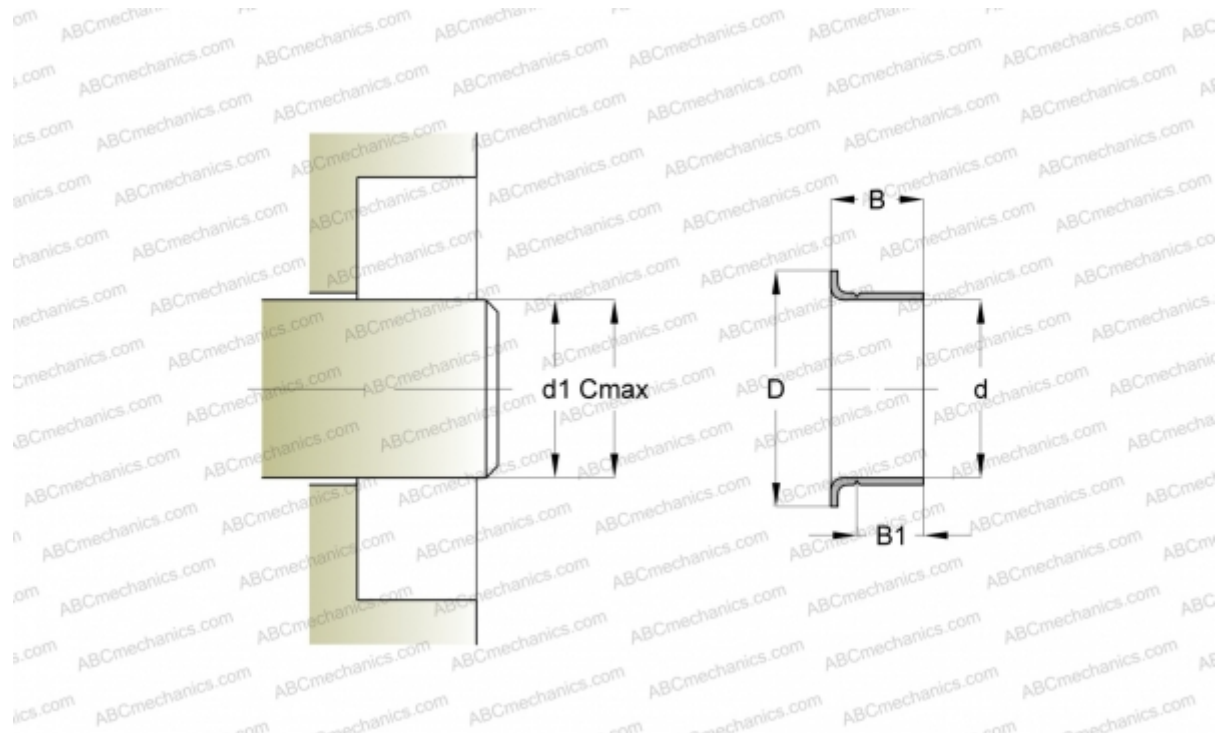

## 99842 SKF

Wear sleeves

TYPE: Wear sleeves, SKF Speedi-Sleeve, Speedi-Sleeve Gold, for heavy industrial applications (SKF)



### Technical specification

#### DIMENSIONS, MM

d1	66,680
d	66,680
D	77,390
B	23,830
B1	19,840
C	66,830

#### MANUFACTURER

[SKF](#)

#### INTERCHANGE

CR	<a href="#">CR 99842</a>
----	--------------------------

#### CALCULATION DATA

Maximum shaft surface speed	0,001 m/s
-----------------------------	-----------

