

99844 SKF

Wear sleeves

TYPE: Wear sleeves, SKF Speedi-Sleeve, Speedi-Sleeve Gold, for heavy industrial applications (SKF)

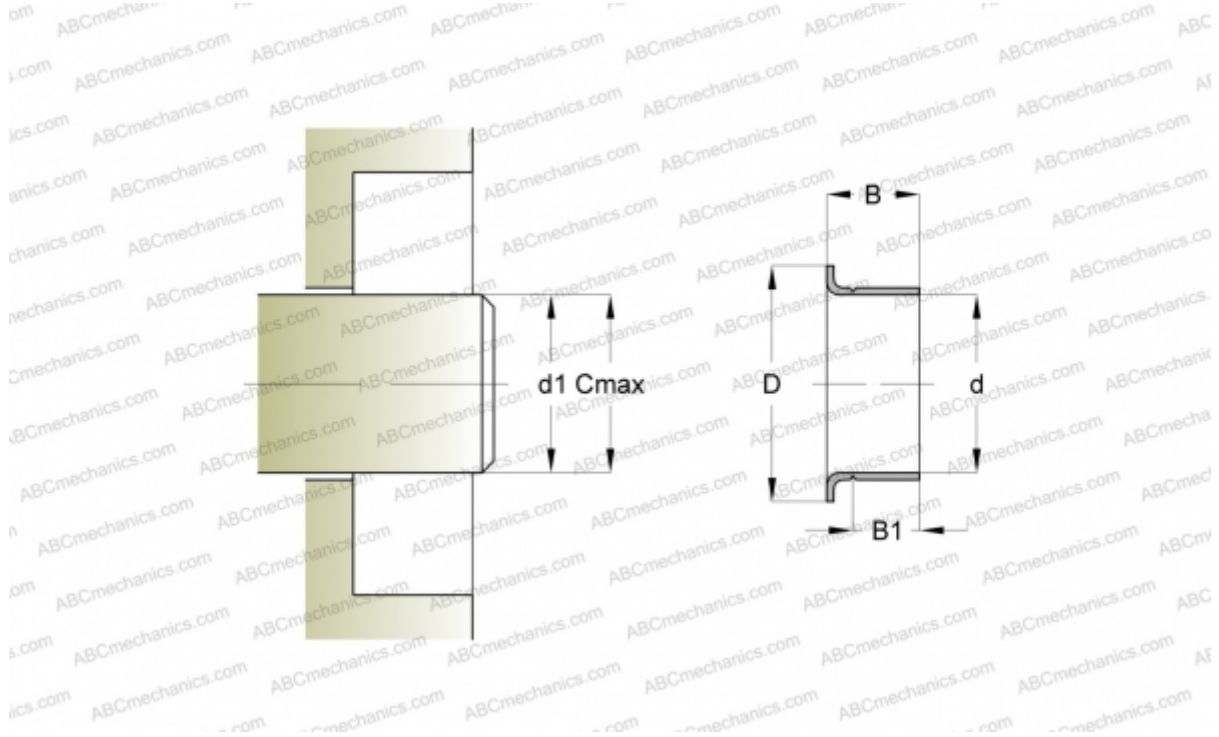

Technical specification

DIMENSIONS, MM

d1	69,850
d	69,850
D	79,380
B	23,830
B1	19,840
C	70,000

MANUFACTURER [SKF](#)

INTERCHANGE

CR [CR 99844](#)

CALCULATION DATA

Maximum shaft surface speed 0,001 m/s