

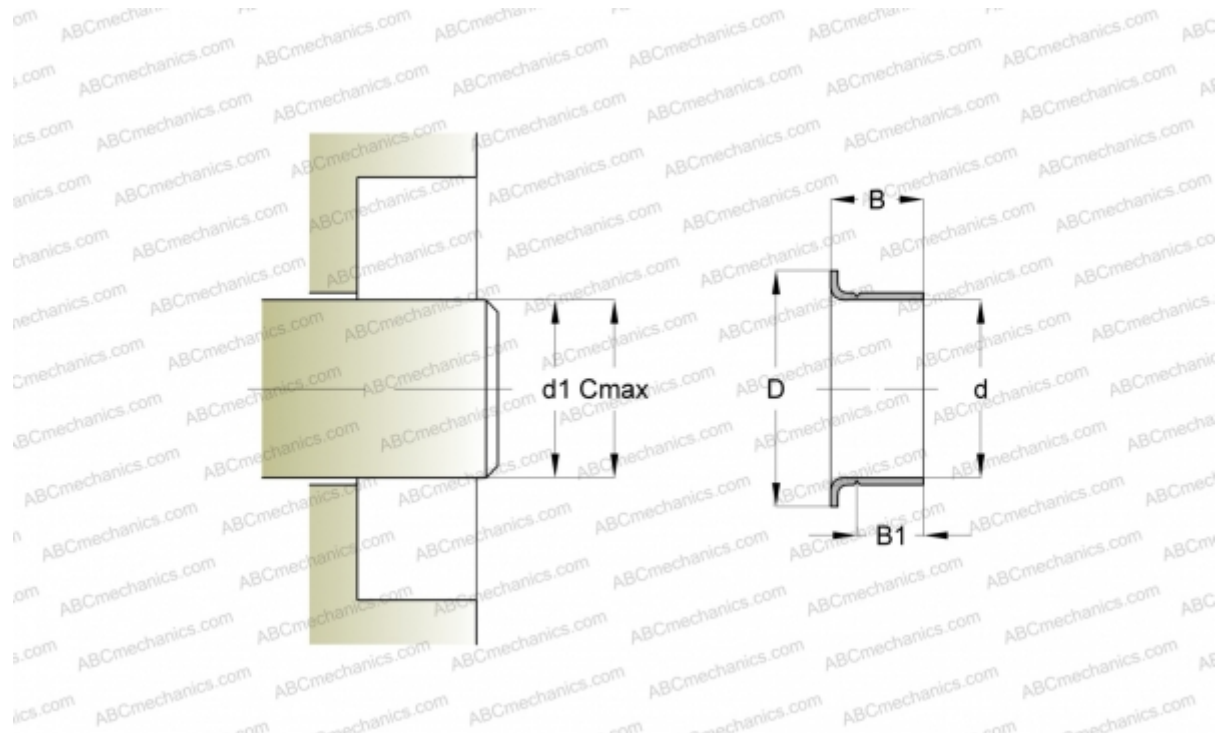

99870 SKF

Wear sleeves

TYPE: Wear sleeves, SKF Speedi-Sleeve, Speedi-Sleeve Gold, for heavy industrial applications (SKF)



Technical specification

DIMENSIONS, MM

d1	71,830
d	72,010
D	81,920
B	22,230
B1	19,050
C	72,010

MANUFACTURER

[SKF](#)

INTERCHANGE

CR	CR 99870
----	--------------------------

CALCULATION DATA

Maximum shaft surface speed	0,001 m/s
-----------------------------	-----------

