

99846 SKF

Wear sleeves

TYPE: Wear sleeves, SKF Speedi-Sleeve, Speedi-Sleeve Gold, for heavy industrial applications (SKF)

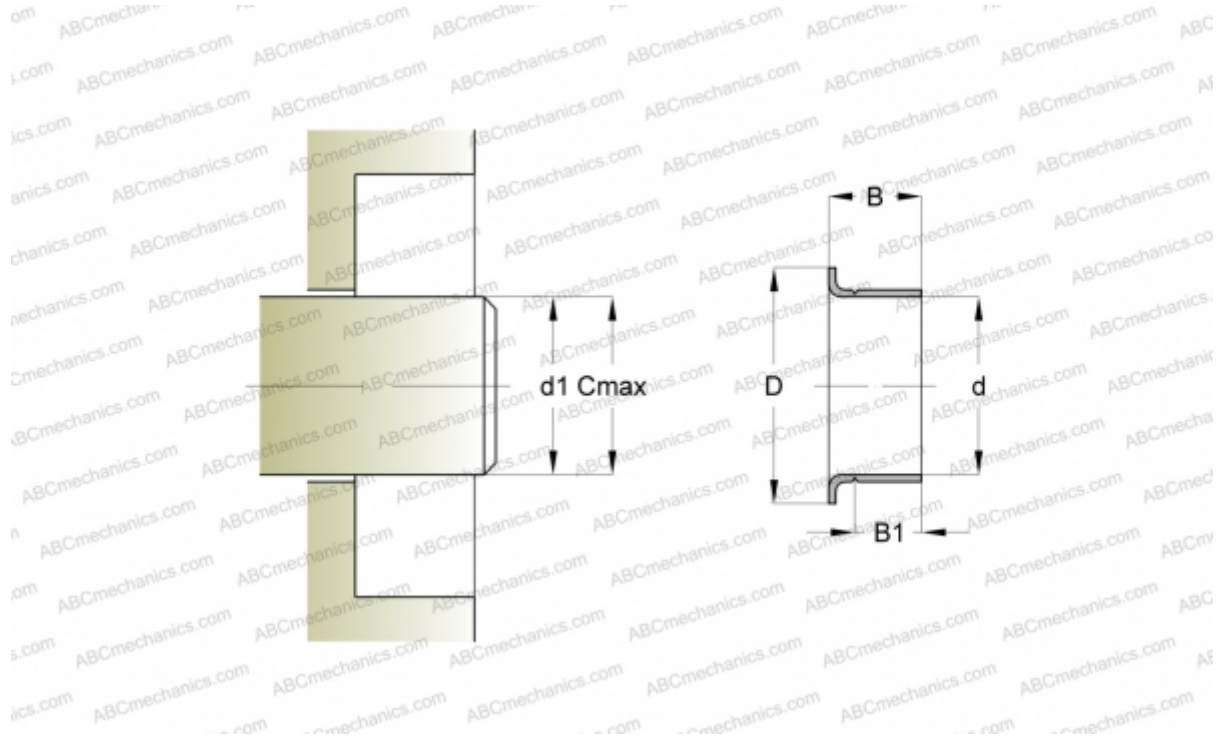

Technical specification

DIMENSIONS, MM

d1	72,970
d	73,030
D	81,760
B	23,830
B1	19,840
C	73,130

MANUFACTURER [SKF](#)

INTERCHANGE

CR [CR 99846](#)

CALCULATION DATA

Maximum shaft surface speed 0,001 m/s