

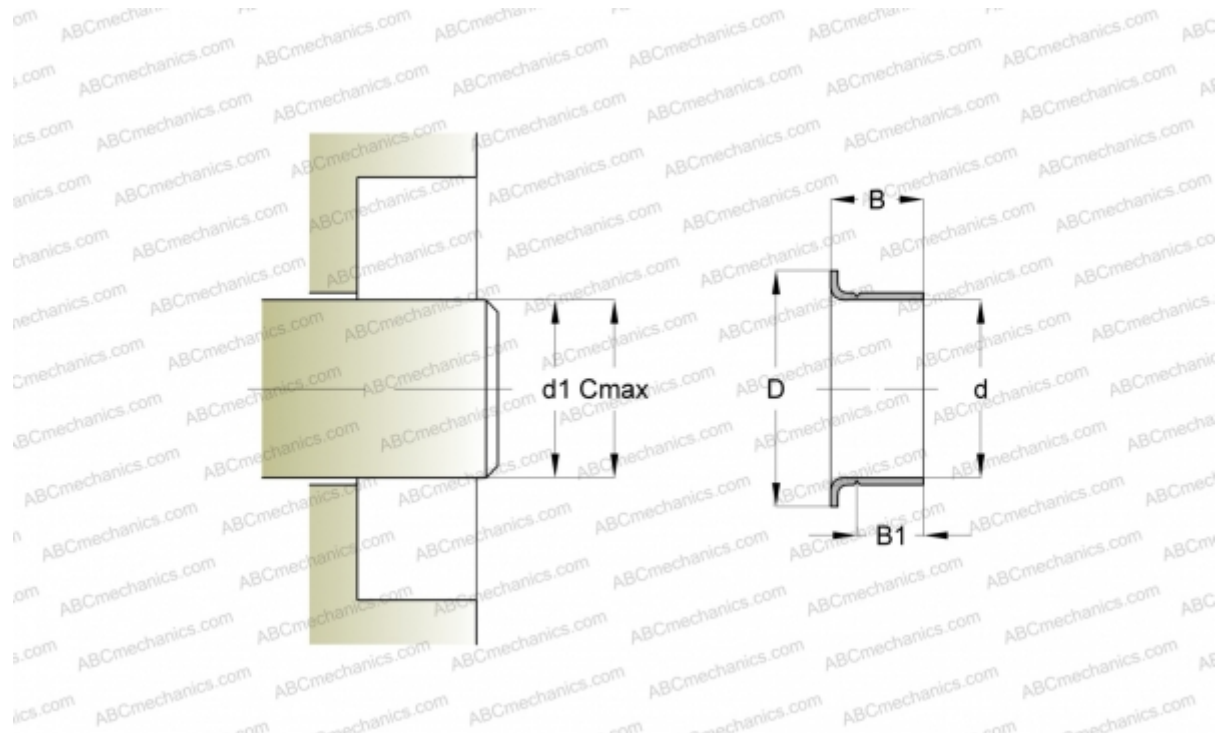

CR 99846 CR

Wear sleeves

TYPE: Wear sleeves, SKF Speedi-Sleeve, Speedi-Sleeve Gold, for heavy industrial applications (SKF)



Technical specification

DIMENSIONS, MM

d1	72,970
d	73,030
D	81,760
B	23,830
B1	19,840
C	73,130

MANUFACTURER

[CR](#)

INTERCHANGE

SKF	99846
-----	-----------------------

CALCULATION DATA

Maximum shaft surface speed	0,001 m/s
-----------------------------	-----------

