

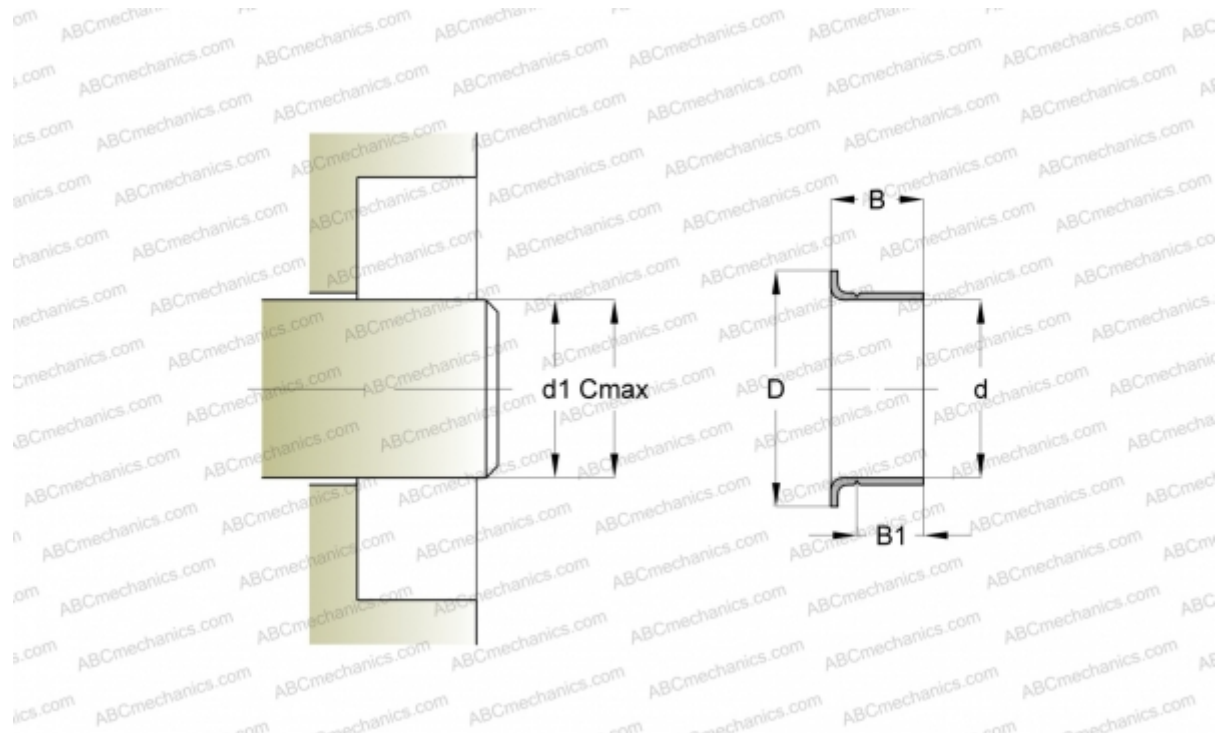

99847 SKF

Wear sleeves

TYPE: Wear sleeves, SKF Speedi-Sleeve, Speedi-Sleeve Gold, for heavy industrial applications (SKF)



Technical specification

DIMENSIONS, MM

d1	74,600
d	74,630
D	84,940
B	23,830
B1	19,840
C	74,750

MANUFACTURER

[SKF](#)

INTERCHANGE

CR	CR 99847
----	--------------------------

CALCULATION DATA

Maximum shaft surface speed	0,001 m/s
-----------------------------	-----------

