

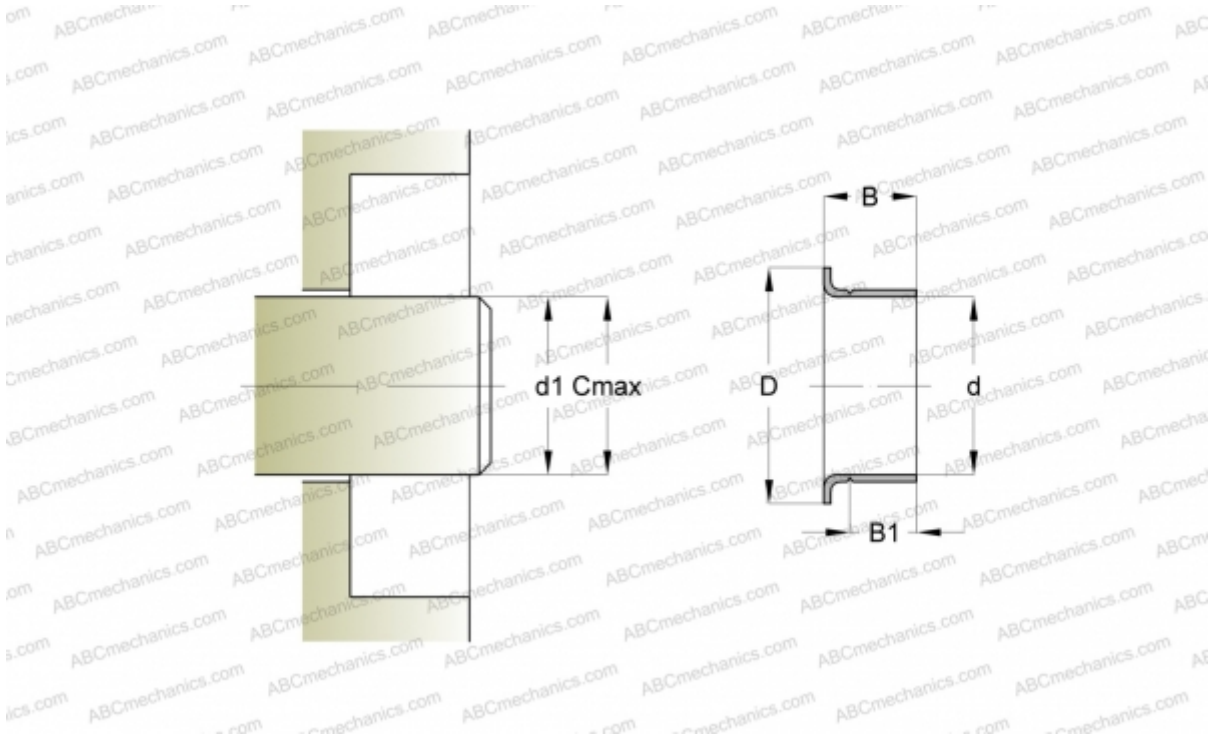

# CR 99851 CR

Wear sleeves

TYPE: Wear sleeves, SKF Speedi-Sleeve, Speedi-Sleeve Gold, for heavy industrial applications (SKF)



## Technical specification

### DIMENSIONS, MM

d1	82,550
d	82,550
D	91,060
B	25,400
B1	20,650
C	82,700

MANUFACTURER [CR](#)

### INTERCHANGE

SKF	<a href="#">99851</a>
-----	-----------------------

### CALCULATION DATA

Maximum shaft surface speed	0,001 m/s
-----------------------------	-----------

