

CR 99853 CR

Wear sleeves

TYPE: Wear sleeves, SKF Speedi-Sleeve, Speedi-Sleeve Gold, for heavy industrial applications (SKF)

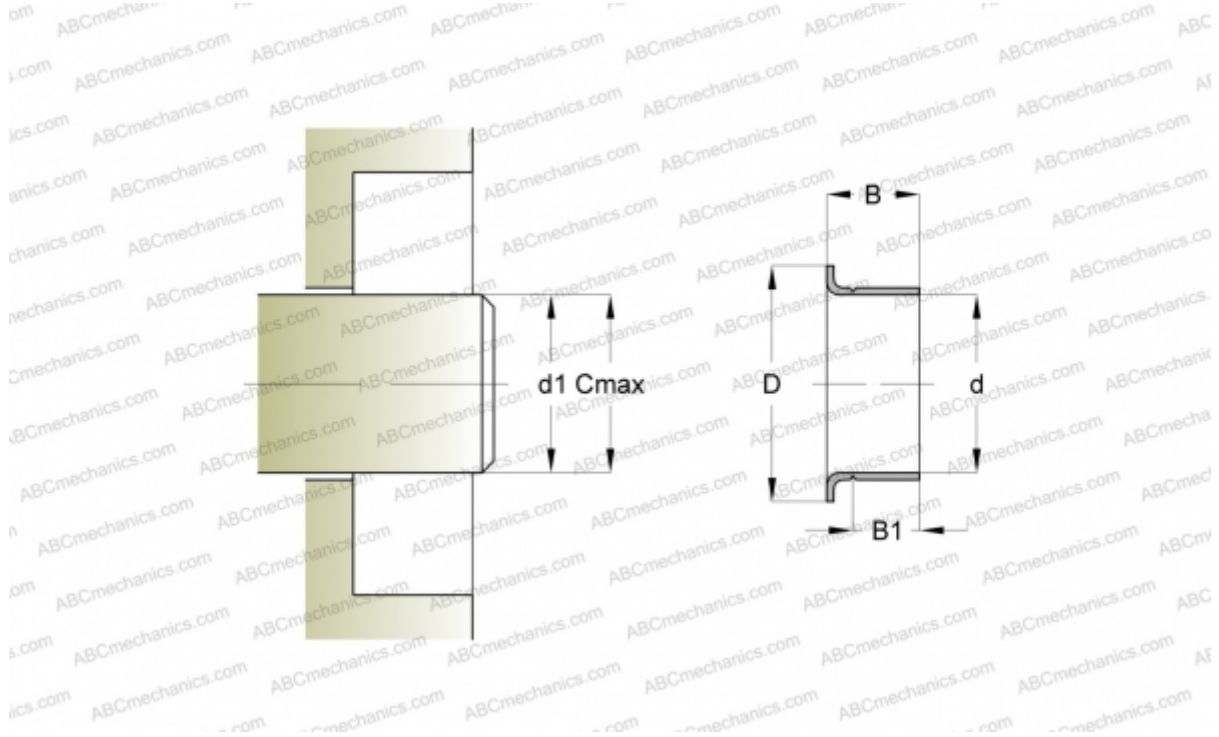

Technical specification

DIMENSIONS, MM

d1	95,250
d	95,250
D	102,110
B	22,230
B1	17,480
C	95,400

MANUFACTURER [CR](#)

INTERCHANGE

SKF [99853](#)

CALCULATION DATA

Maximum shaft surface speed 0,001 m/s