

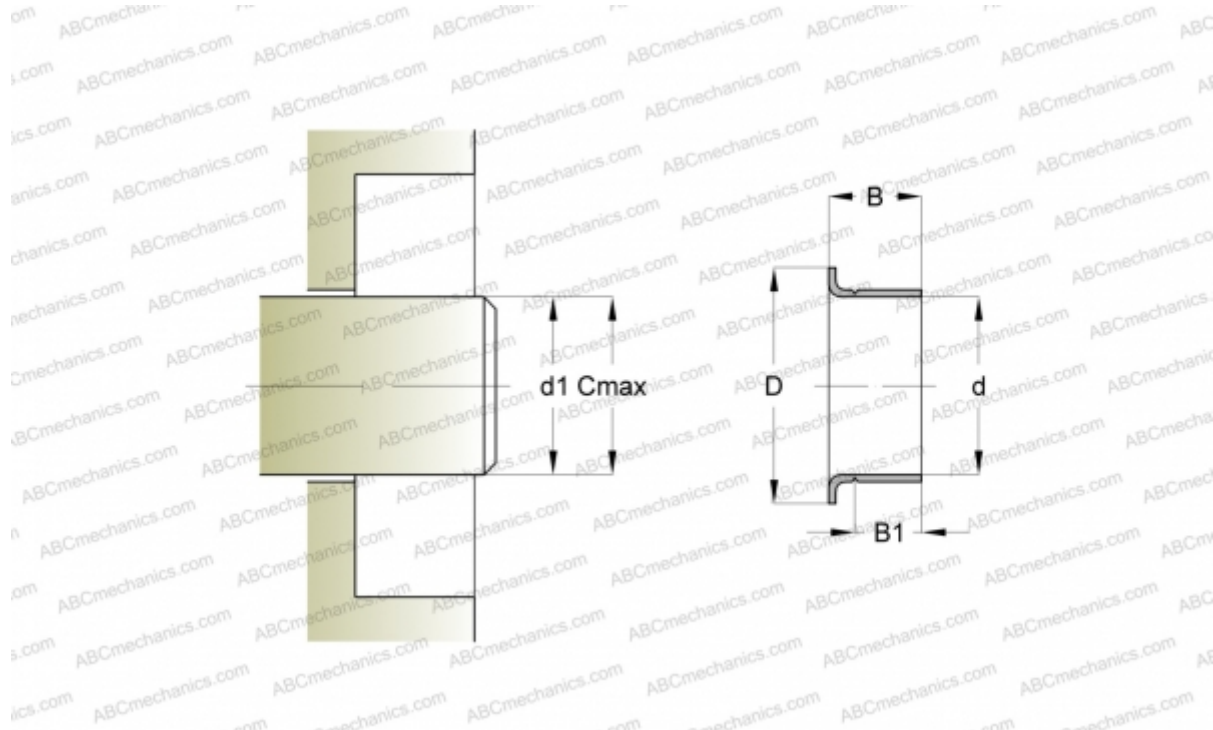

99856 SKF

Wear sleeves

TYPE: Wear sleeves, SKF Speedi-Sleeve, Speedi-Sleeve Gold, for heavy industrial applications (SKF)



Technical specification

DIMENSIONS, MM

d1	114,200
d	114,300
D	123,190
B	25,400
B1	20,650
C	114,400

MANUFACTURER

[SKF](#)

INTERCHANGE

CR	CR 99856
----	--------------------------

CALCULATION DATA

Maximum shaft surface speed	0,001 m/s
-----------------------------	-----------

