

99857 SKF

Wear sleeves

TYPE: Wear sleeves, SKF Speedi-Sleeve, Speedi-Sleeve Gold, for heavy industrial applications (SKF)

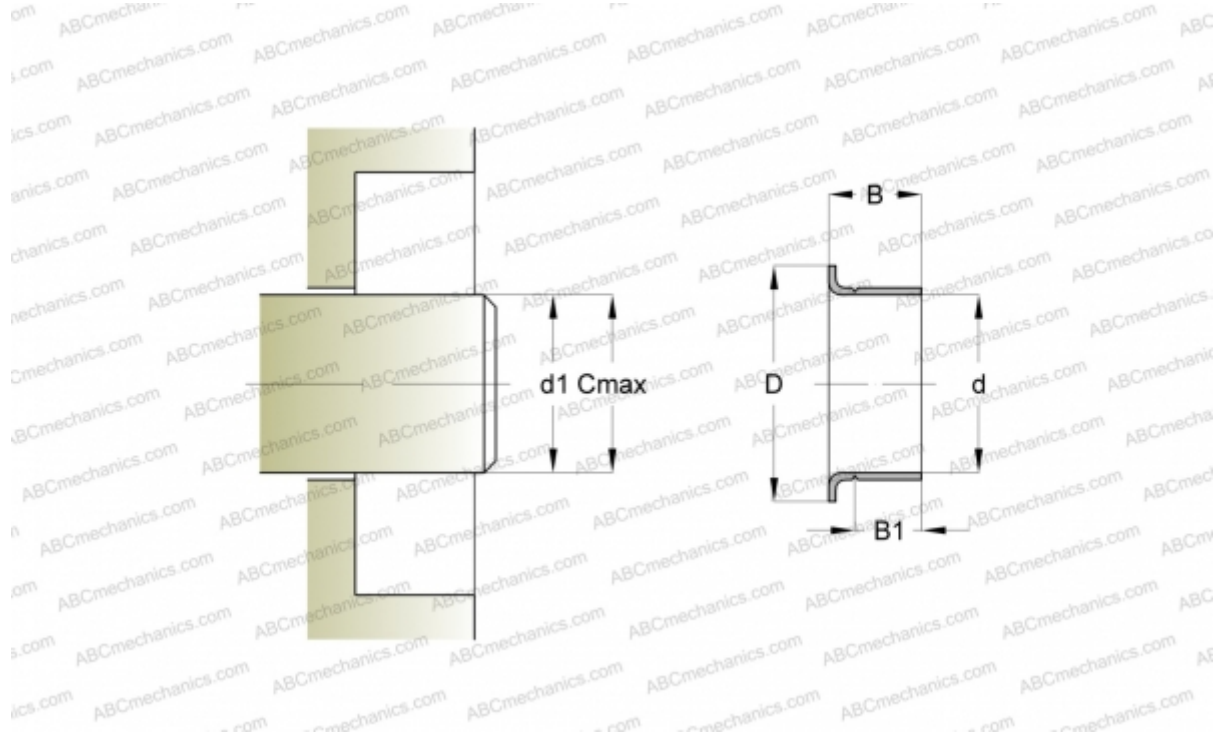

Technical specification

DIMENSIONS, MM

d1	126,950
d	127,000
D	137,160
B	22,230
B1	17,480
C	127,150

MANUFACTURER [SKF](#)

INTERCHANGE

CR [CR 99857](#)

CALCULATION DATA

Maximum shaft surface speed 0,001 m/s