

99858 SKF

Wear sleeves

TYPE: Wear sleeves, SKF Speedi-Sleeve, Speedi-Sleeve Gold, for heavy industrial applications (SKF)

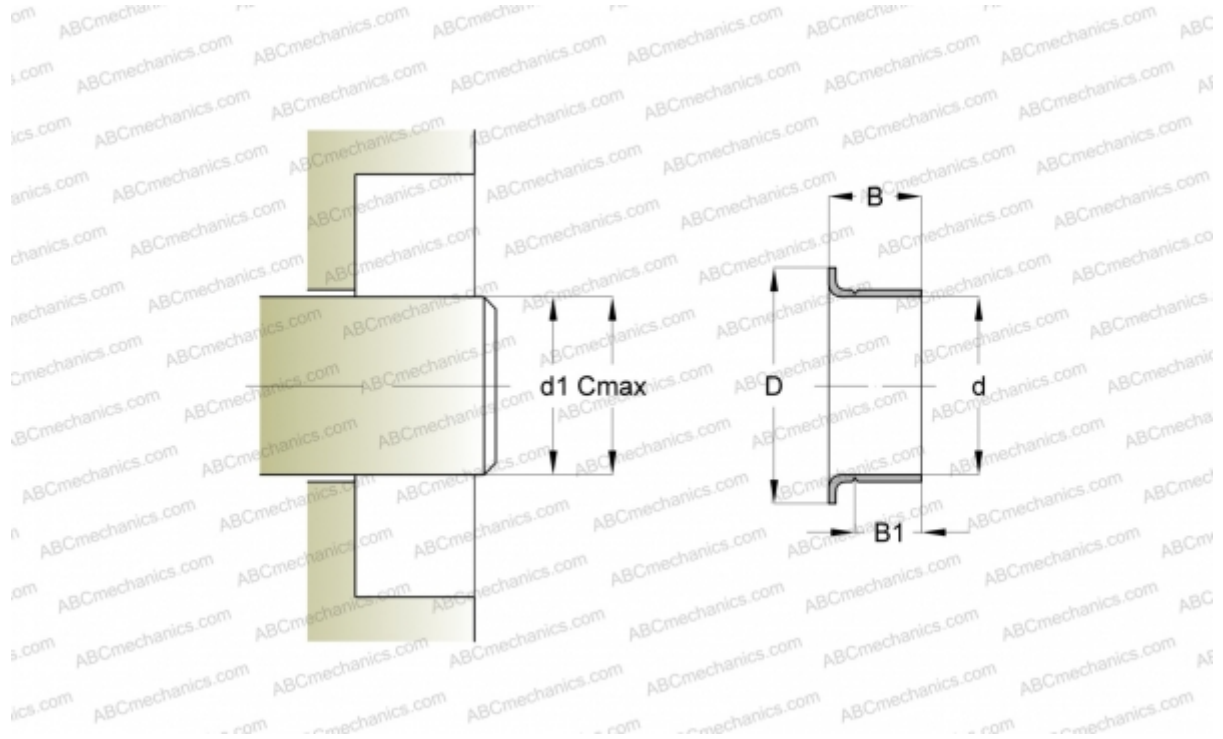

Technical specification

DIMENSIONS, MM

d1	126,950
d	127,000
D	136,910
B	25,400
B1	20,650
C	127,150

MANUFACTURER [SKF](#)

INTERCHANGE

CR [CR 99858](#)

CALCULATION DATA

Maximum shaft surface speed 0,001 m/s