

## CR 99858 CR

Wear sleeves

TYPE: Wear sleeves, SKF Speedi-Sleeve, Speedi-Sleeve Gold, for heavy industrial applications (SKF)

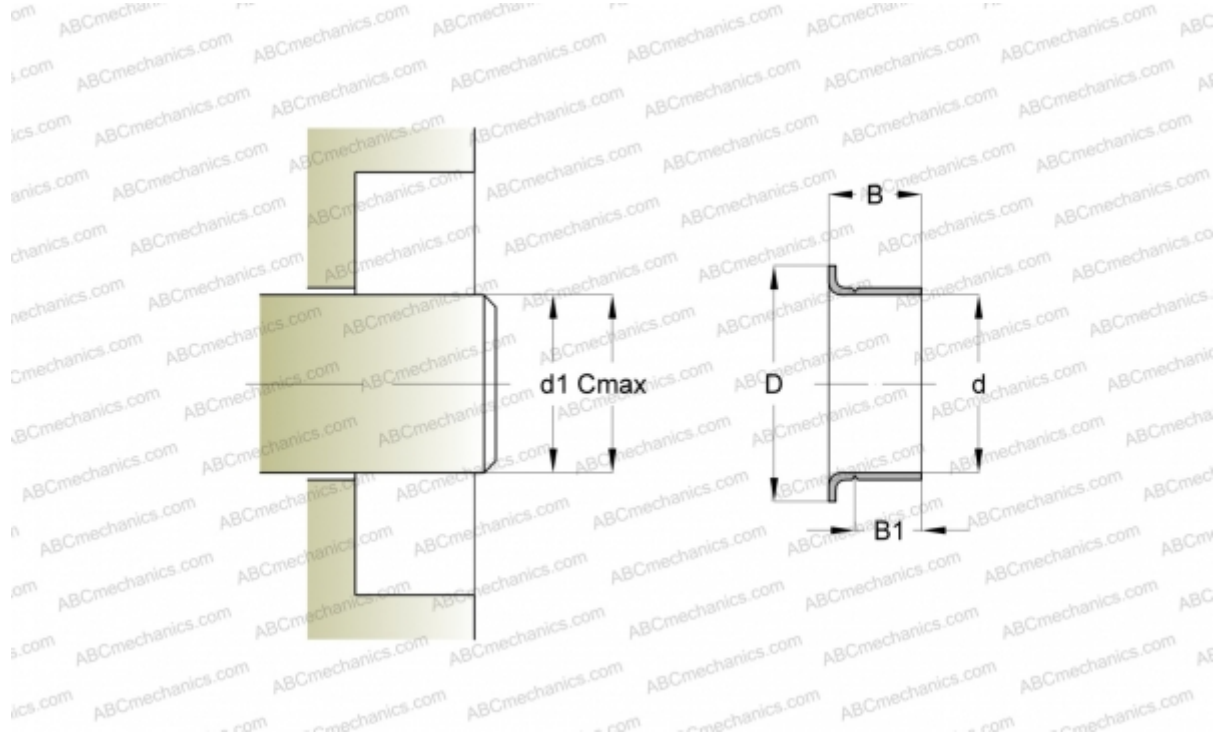

### Technical specification

#### DIMENSIONS, MM

d1	126,950
d	127,000
D	136,910
B	25,400
B1	20,650
C	127,150

**MANUFACTURER** [CR](#)

#### INTERCHANGE

SKF [99858](#)

#### CALCULATION DATA

Maximum shaft surface speed 0,001 m/s