

## 99874 SKF

Wear sleeves

TYPE: Wear sleeves, SKF Speedi-Sleeve, Speedi-Sleeve Gold, for heavy industrial applications (SKF)

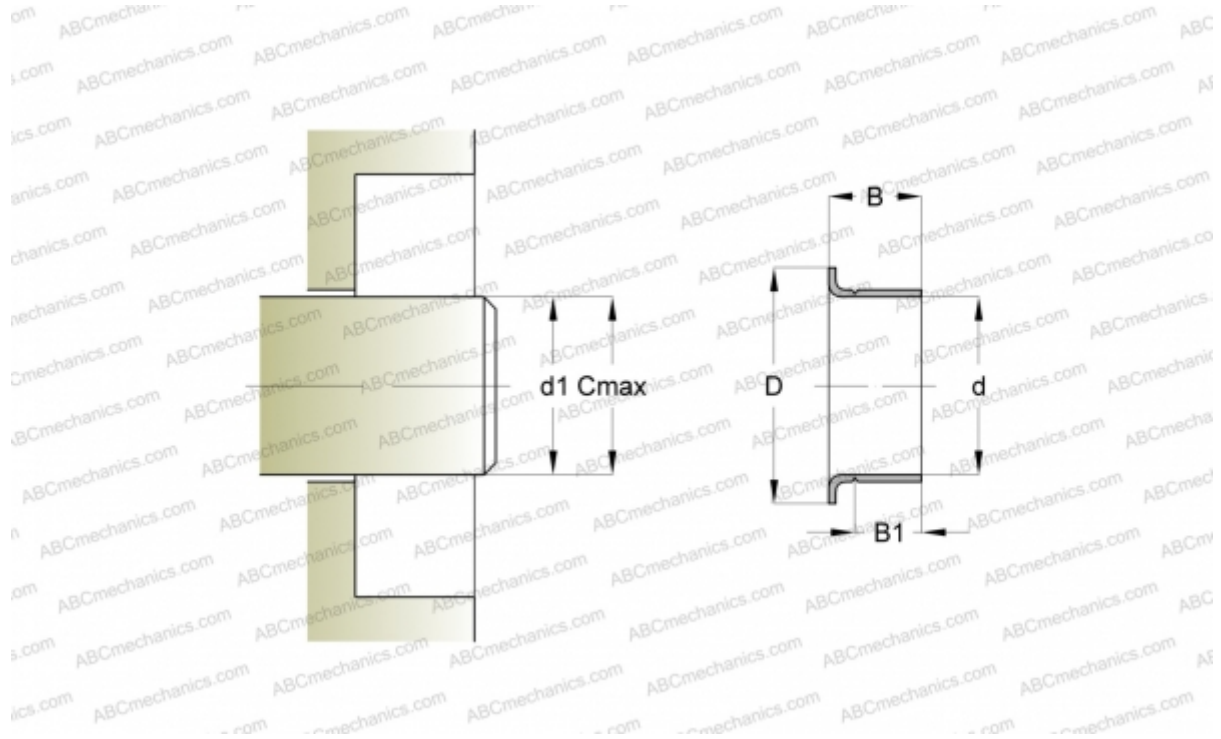

### Technical specification

#### DIMENSIONS, MM

d1	129,970
d	130,000
D	139,520
B	25,300
B1	22,000
C	130,180

#### MANUFACTURER

[SKF](#)

#### INTERCHANGE

CR	<a href="#">CR 99874</a>
----	--------------------------

#### CALCULATION DATA

Maximum shaft surface speed	0,001 m/s
-----------------------------	-----------