

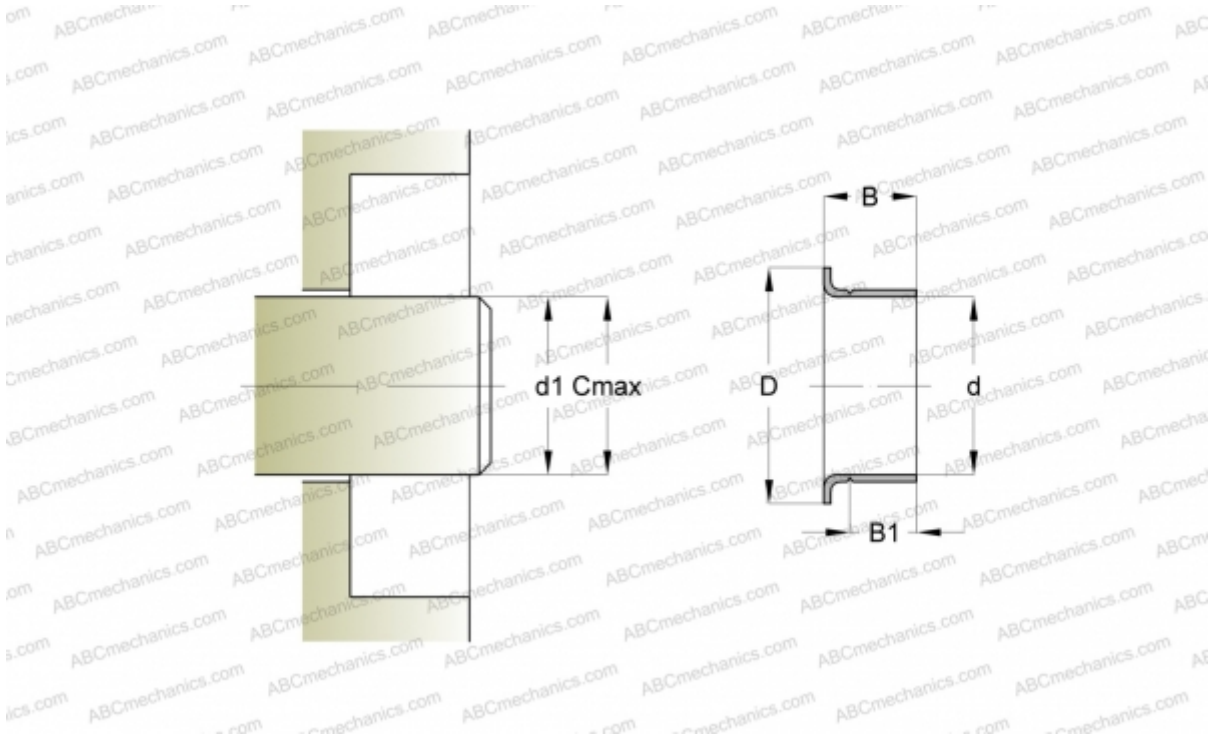

CR 99874 CR

Wear sleeves

TYPE: Wear sleeves, SKF Speedi-Sleeve, Speedi-Sleeve Gold, for heavy industrial applications (SKF)



Technical specification

DIMENSIONS, MM

d1	129,970
d	130,000
D	139,520
B	25,300
B1	22,000
C	130,180

MANUFACTURER [CR](#)

INTERCHANGE

SKF	99874
-----	-----------------------

CALCULATION DATA

Maximum shaft surface speed	0,001 m/s
-----------------------------	-----------

