

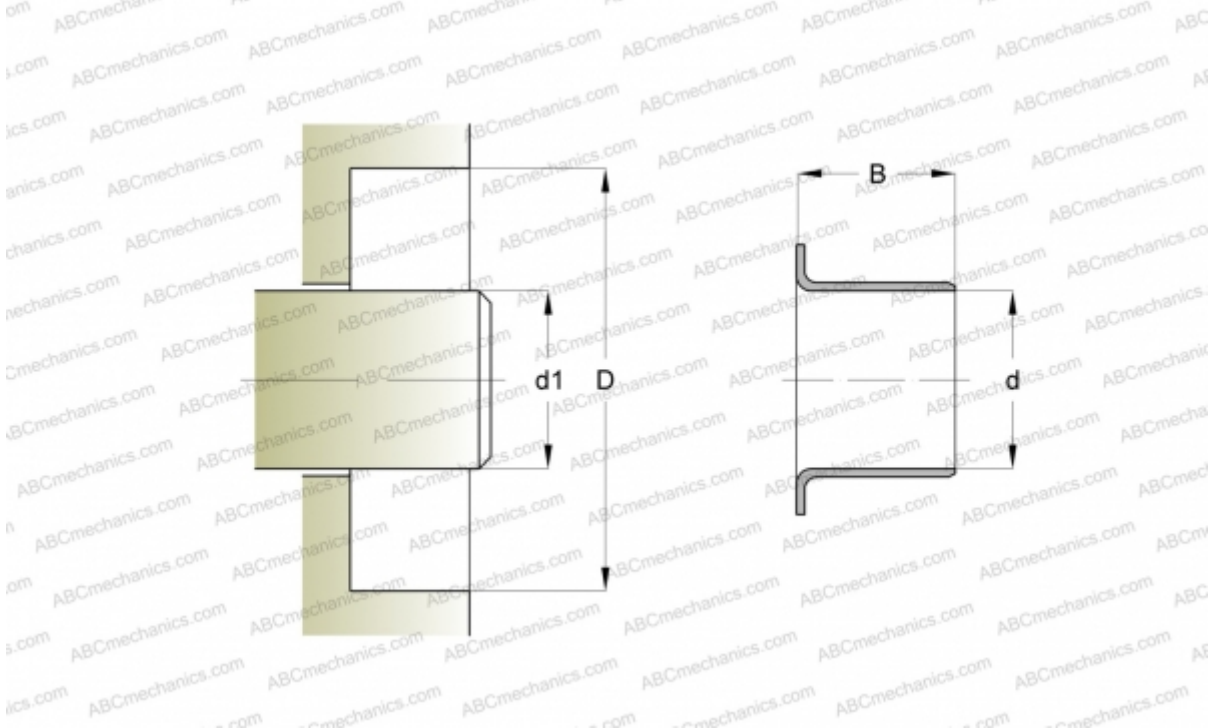

# 87831 SKF

Wear sleeves

TYPE: Wear sleeves, Wear sleeves for heavy industrial applications, Type LDSLV3 (SKF)



## Technical specification

### DIMENSIONS, MM

d1	215,200
d	215,200
B	35,000

MANUFACTURER [SKF](#)

### CALCULATION DATA

Maximum shaft surface speed	0,001 m/s
-----------------------------	-----------

