

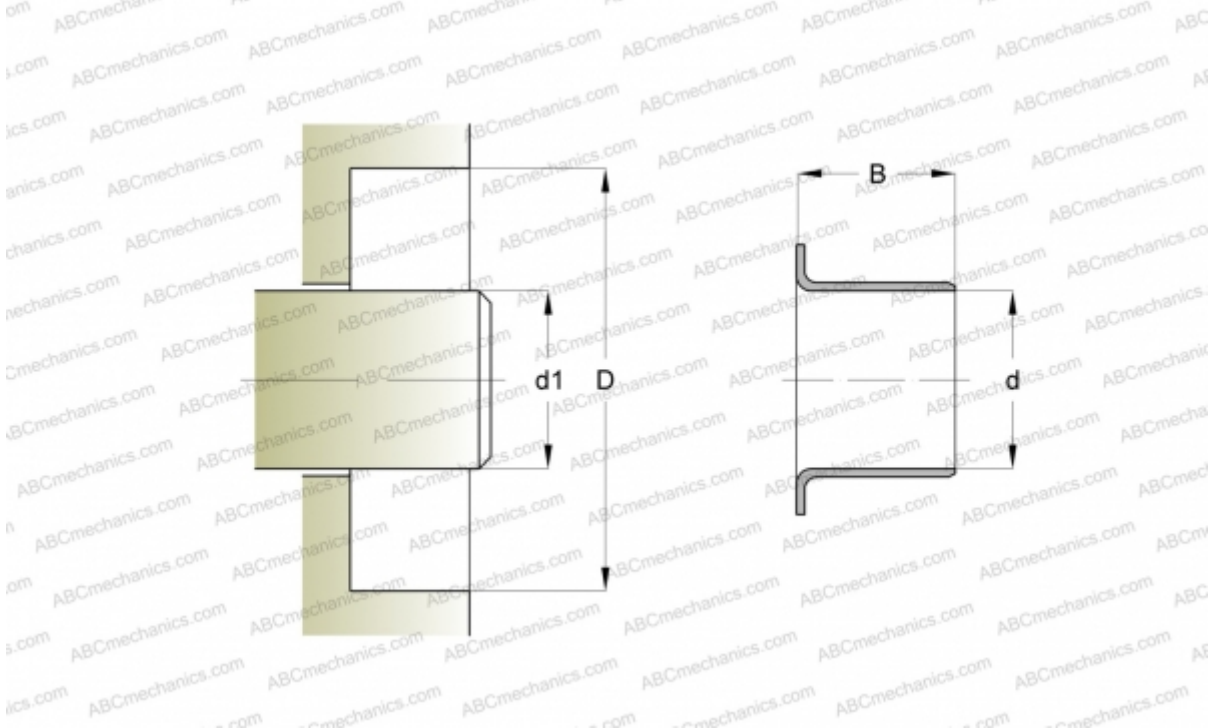

# 85643 SKF

Wear sleeves

TYPE: Wear sleeves, Wear sleeves for heavy industrial applications, Type LDSLV3 (SKF)



## Technical specification

### DIMENSIONS, MM

d1	219,080
d	219,080
B	69,850

MANUFACTURER [SKF](#)

### CALCULATION DATA

Maximum shaft surface speed	0,001 m/s
-----------------------------	-----------

