

85800 SKF

Wear sleeves

TYPE: Wear sleeves, Wear sleeves for heavy industrial applications, Type LDSLV3 (SKF)

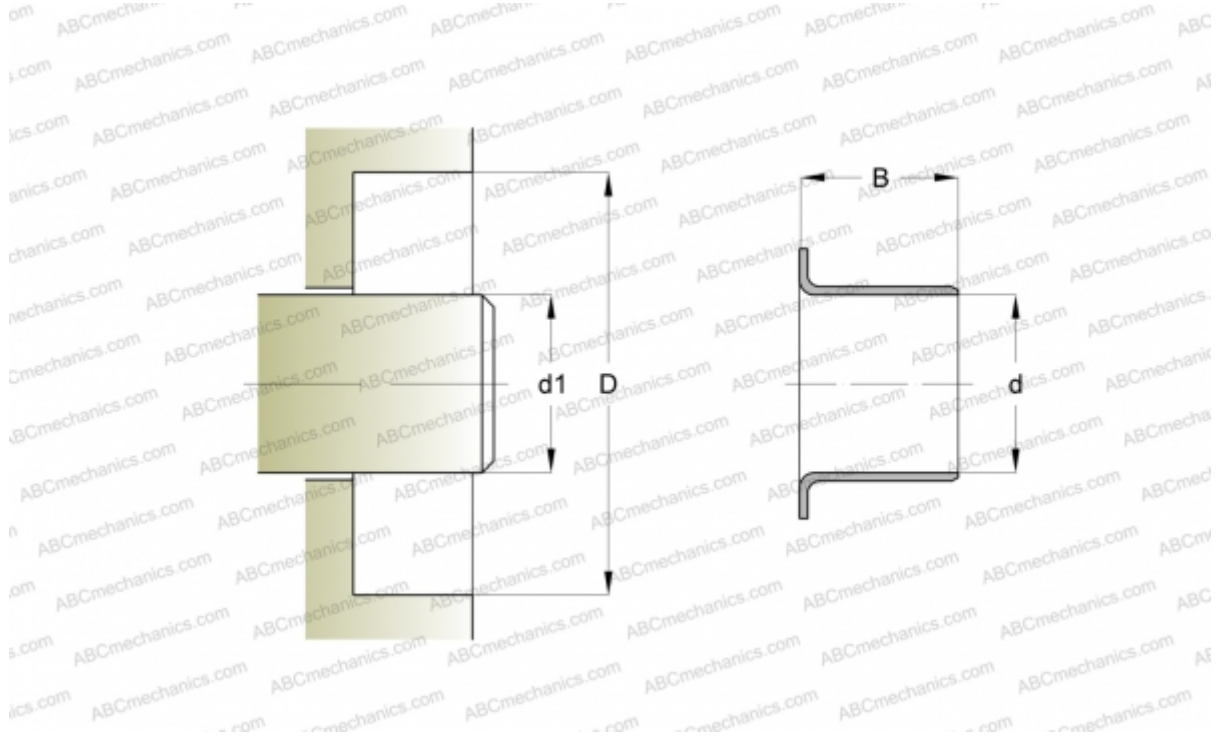

Technical specification

DIMENSIONS, MM

d1	528,650
d	528,650
B	31,750

MANUFACTURER [SKF](#)

CALCULATION DATA

Maximum shaft surface speed	0,001 m/s
-----------------------------	-----------