

## 85367 SKF

Wear sleeves

TYPE: Wear sleeves, Wear sleeves for heavy industrial applications, Type LDSLV4 (SKF)

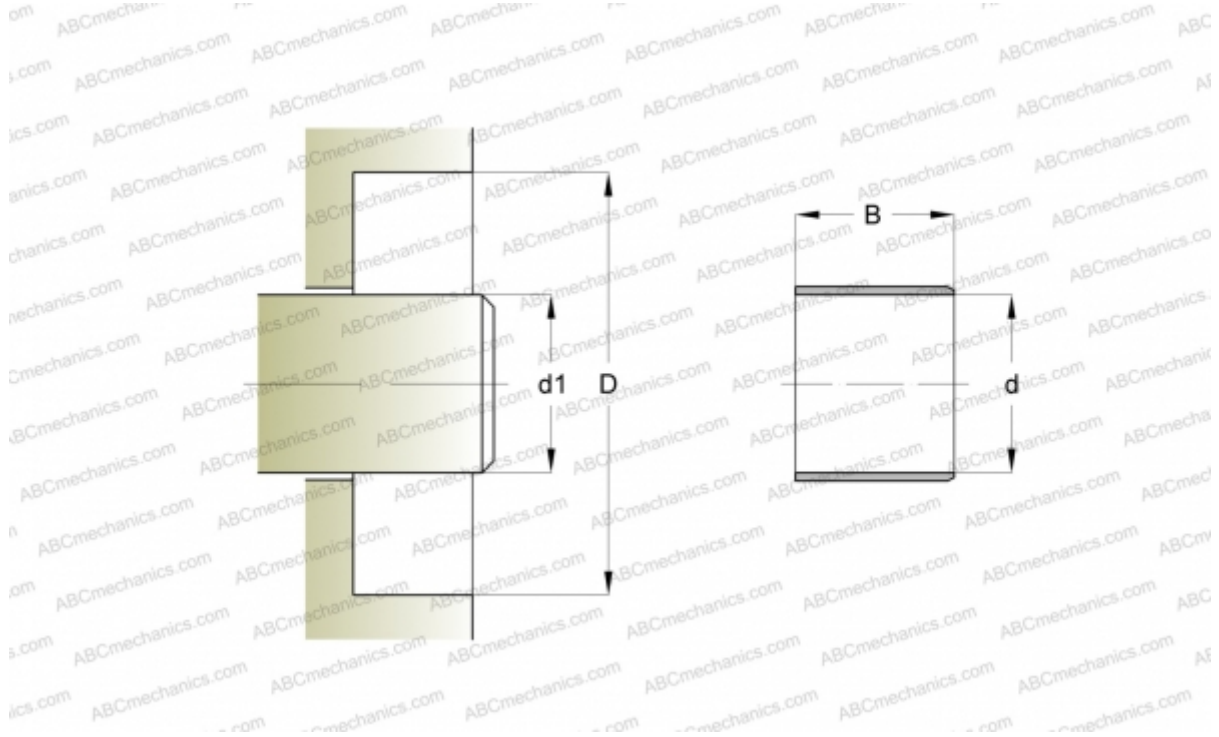

### Technical specification

#### DIMENSIONS, MM

$d_1$	528,650
$d$	528,650
$B$	53,980

**MANUFACTURER** [SKF](#)

#### CALCULATION DATA

Maximum shaft surface speed	0,001 m/s
-----------------------------	-----------