

81826 SKF

Wear sleeves

TYPE: Wear sleeves, Wear sleeves for heavy industrial applications, Type LDSLV4 (SKF)

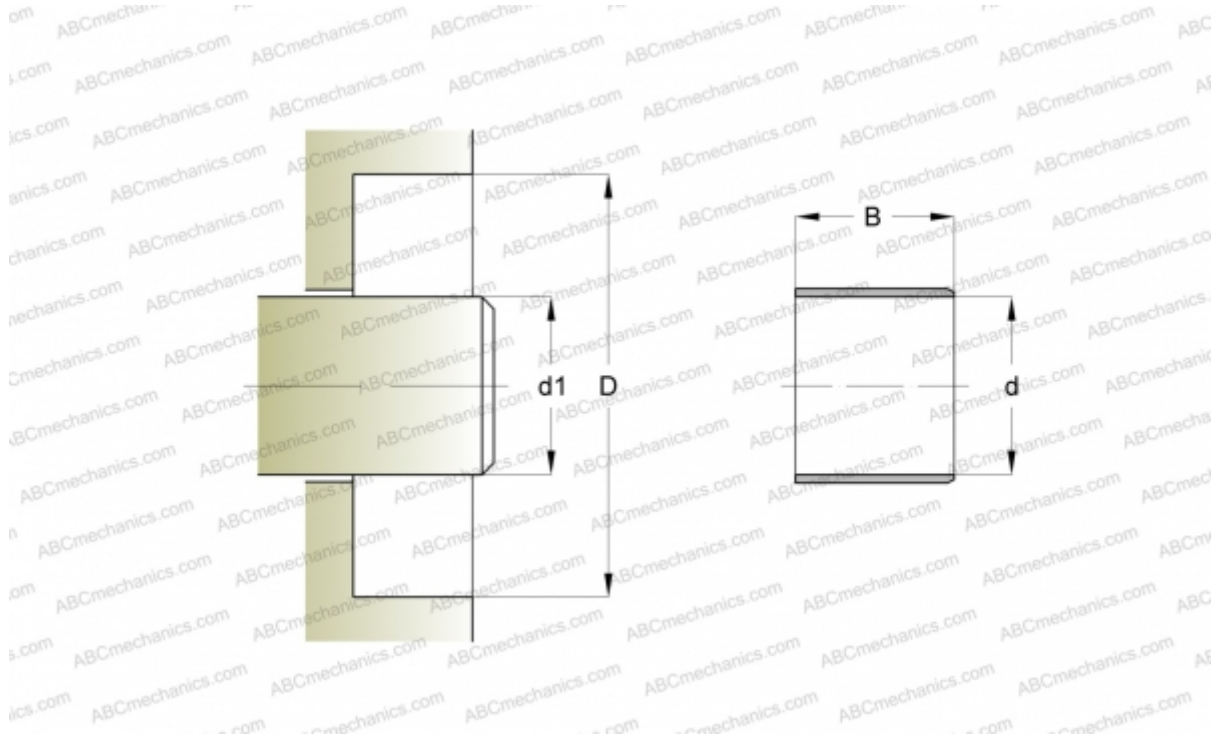

Technical specification

DIMENSIONS, MM

d1	1011,250
d	1011,250
B	53,980

MANUFACTURER [SKF](#)

CALCULATION DATA

Maximum shaft surface speed	0,001 m/s
-----------------------------	-----------