

KSR15-B0-06-10-20-08 INA

Roller chain idler sprocket unit

TYPE: Simplex, Roller chain idler sprocket units, Sprocket made from steel or sintered iron, type KSR...-BO (INA)

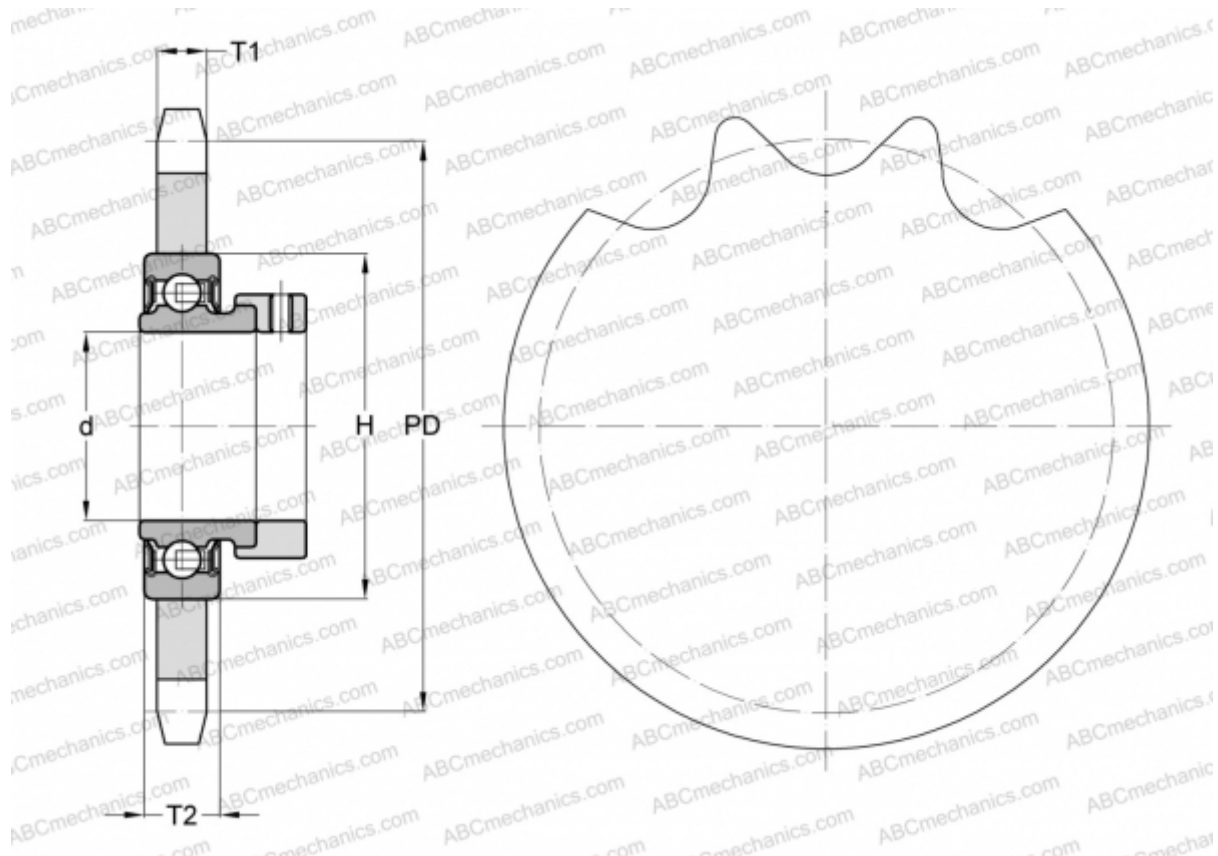

Technical specification

DIMENSIONS, MM

Pitch, p	9,525
Pitch diameter, PD	60,900
Dimensions bore, min	15,000
Dimensions bore, max	15,000
Hub, H	40,000
Thickness, T1	5,200
Thickness, T2	12,000
Number of teeth	20

WEIGHT, KG 0,180

MANUFACTURER [INA](#)