

KSR25-B0-08-10-19-08 INA

Roller chain idler sprocket unit

TYPE: Simplex, Roller chain idler sprocket units, Sprocket made from steel or sintered iron, type KSR...-BO (INA)

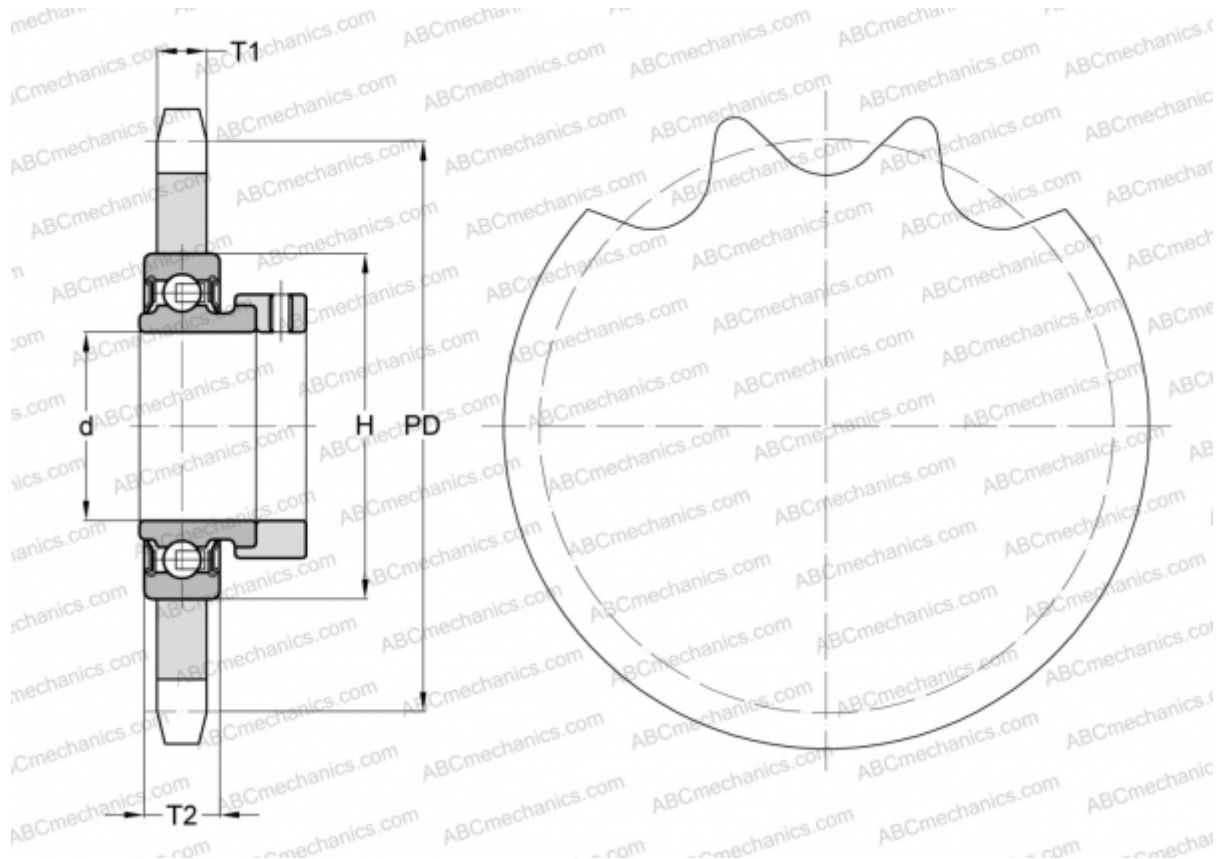

Technical specification

DIMENSIONS, MM

Pitch, p	12,700
Pitch diameter, PD	77,100
Dimensions bore, min	25,000
Dimensions bore, max	25,000
Hub, H	52,000
Thickness, T1	7,000
Thickness, T2	15,000
Number of teeth	19

WEIGHT, KG 0,290

MANUFACTURER [INA](#)