

## KSR15-B0-10-10-14-08 INA

Roller chain idler sprocket unit

TYPE: Simplex, Roller chain idler sprocket units, Sprocket made from steel or sintered iron, type KSR...-BO (INA)

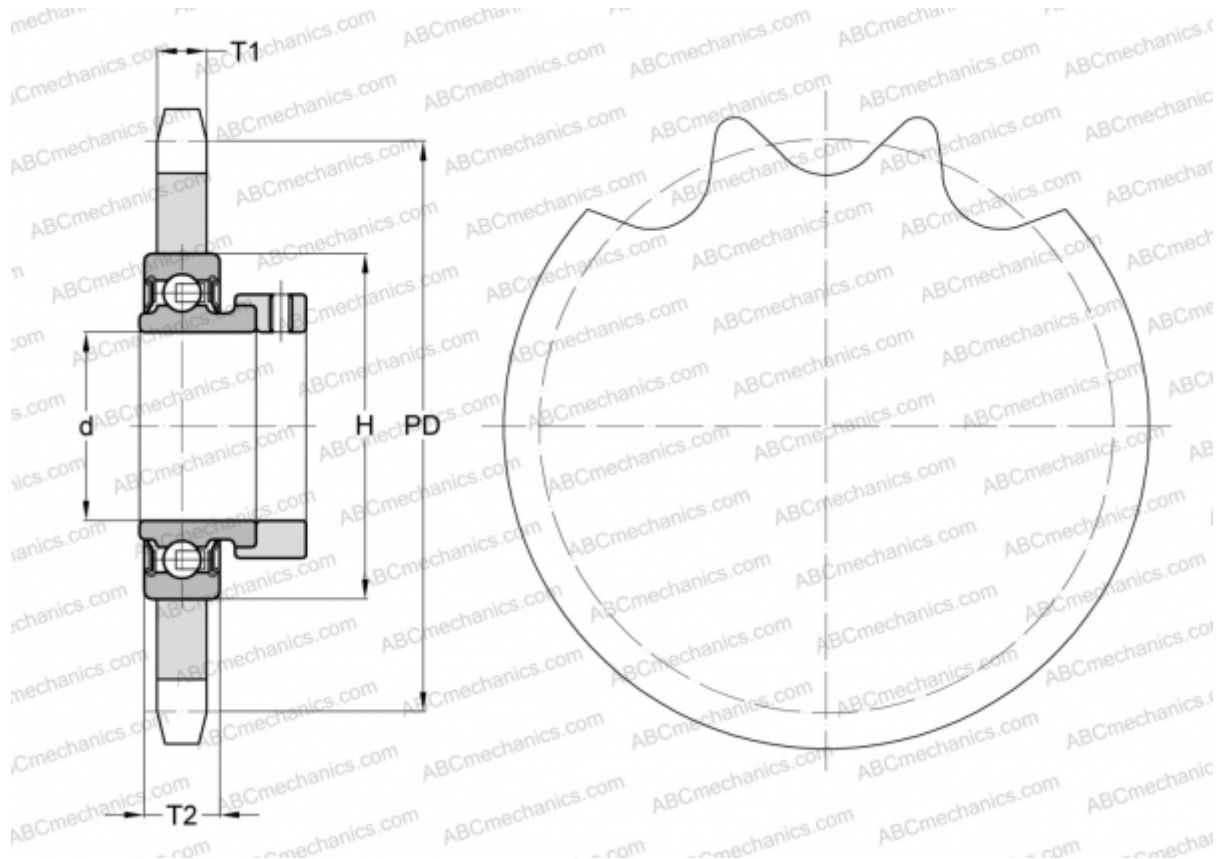

### Technical specification

#### DIMENSIONS, MM

Pitch, p	15,875
Pitch diameter, PD	71,300
Dimensions bore, min	15,000
Dimensions bore, max	15,000
Hub, H	40,000
Thickness, T1	8,700
Thickness, T2	12,000
Number of teeth	14

**WEIGHT, KG** 0,260

**MANUFACTURER** [INA](#)