

SYK 35 TF SKF

Ball bearing units

TYPE: Housing units, Plummer block, Cast iron housing, Radial insert ball bearing with grub screws in inner ring, Type SYK..TF (SKF), composite

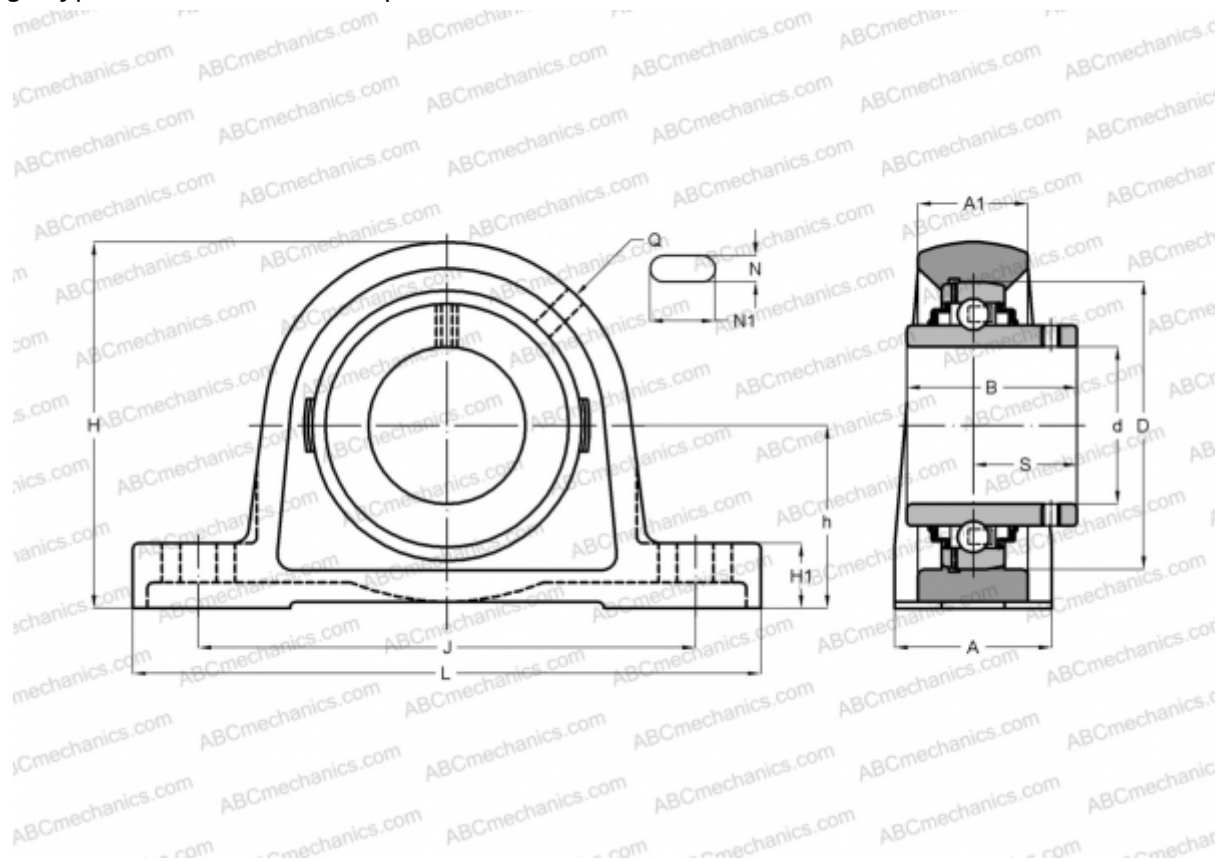

Technical specification

DIMENSIONS, MM

d	35,000
D	72,000
B	42,900
L	164,000
H	93,000
A	45,000
J	126,000
A1	27,000
H1	19,000
N	14,500
N1	21,500
S	25,400
h	47,600

WEIGHT, KG 0,660

Bearing	YAR 207-2F
Housing	SYK 507
Protective cover	ECY 207

MANUFACTURER

[SKF](#)

CALCULATION DATA

Basic dynamic load rating, C	25,500 kN
Basic static load rating, Co	15,300 kN
Fatigue load limit, Pu	0,655 kN
Limiting speed	5300 r/min