

## SYF 30 FM SKF

Ball bearing units

TYPE: Housing units, Plummer block, Narrow cast iron housing, Radial insert ball bearing with eccentric locking collar, Type SYF..FM (SKF)

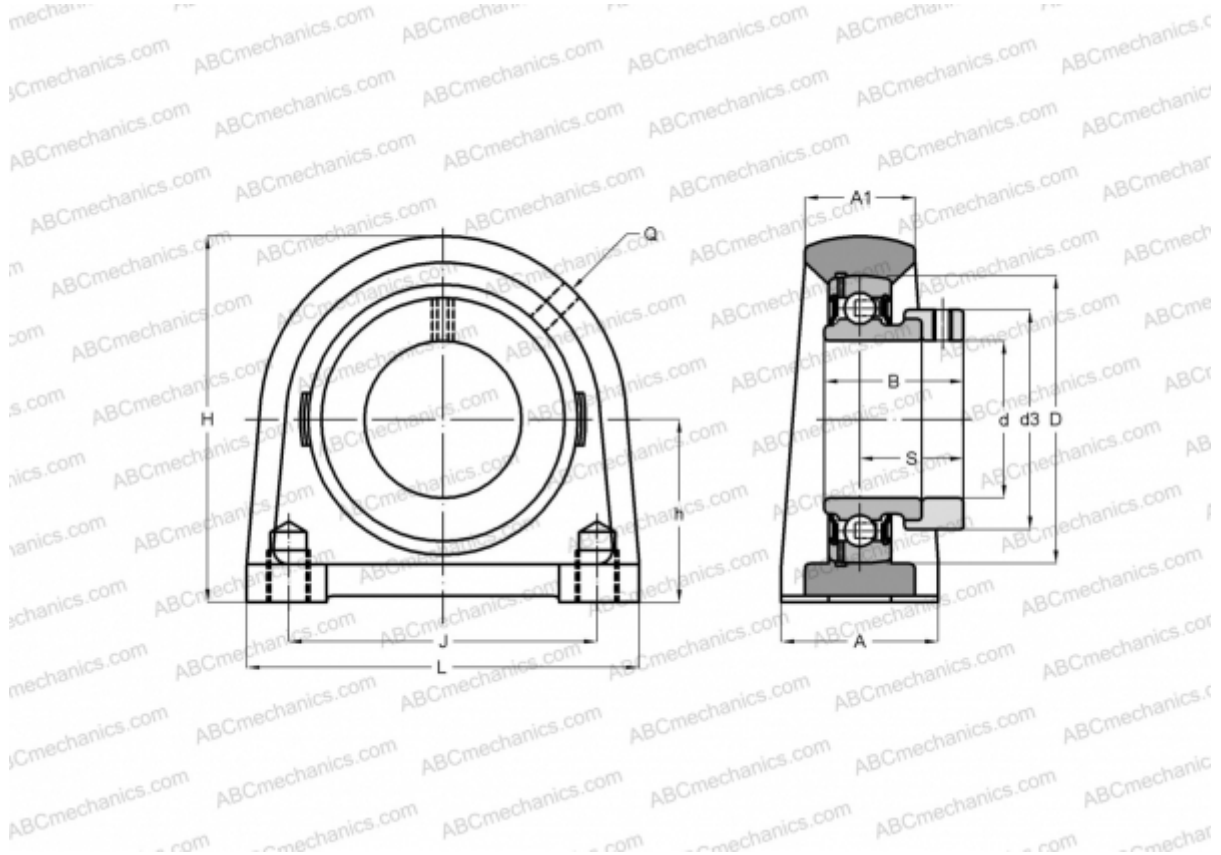

### Technical specification

#### DIMENSIONS, MM

d	30,000
D	62,000
B	35,700
L	98,000
H	83,000
A	40,000
J	76,200
A1	25,000
S	26,700
h	42,900

#### WEIGHT, KG

0,900

Bearing	YET 206
Housing	SYF 506

#### MANUFACTURER

[SKF](#)

#### CALCULATION DATA

Basic dynamic load rating, C	19,500 kN
Basic static load rating, Co	11,200 kN
Fatigue load limit, Pu	0,475 kN
Limiting speed	6300 r/min