

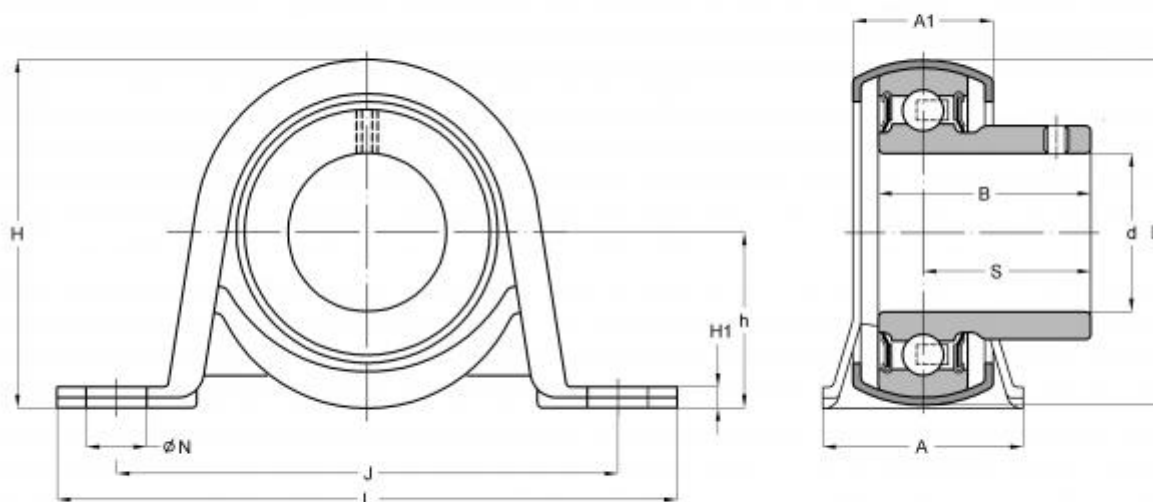

## P 25 RM SKF

Ball bearing units

TYPE: Housing units, Plummer block, Sheet steel housing, Radial insert ball bearing with grub screws in inner ring, Type P..RM (SKF)



### Technical specification

#### DIMENSIONS, MM

d	25,000
D	52,000
B	27,200
L	108,000
H	56,000
A	32,000
J	86,000
A1	24,000
H1	3,200
N	11,200
S	19,500
h	28,300

**WEIGHT, KG** 0,240

Bearing	YAT 205
Housing	P 52

#### MANUFACTURER

[SKF](#)

#### CALCULATION DATA

Basic dynamic load rating, C	14,000 kN
Basic static load rating, Co	7,800 kN
Fatigue load limit, Pu	0,335 kN

