

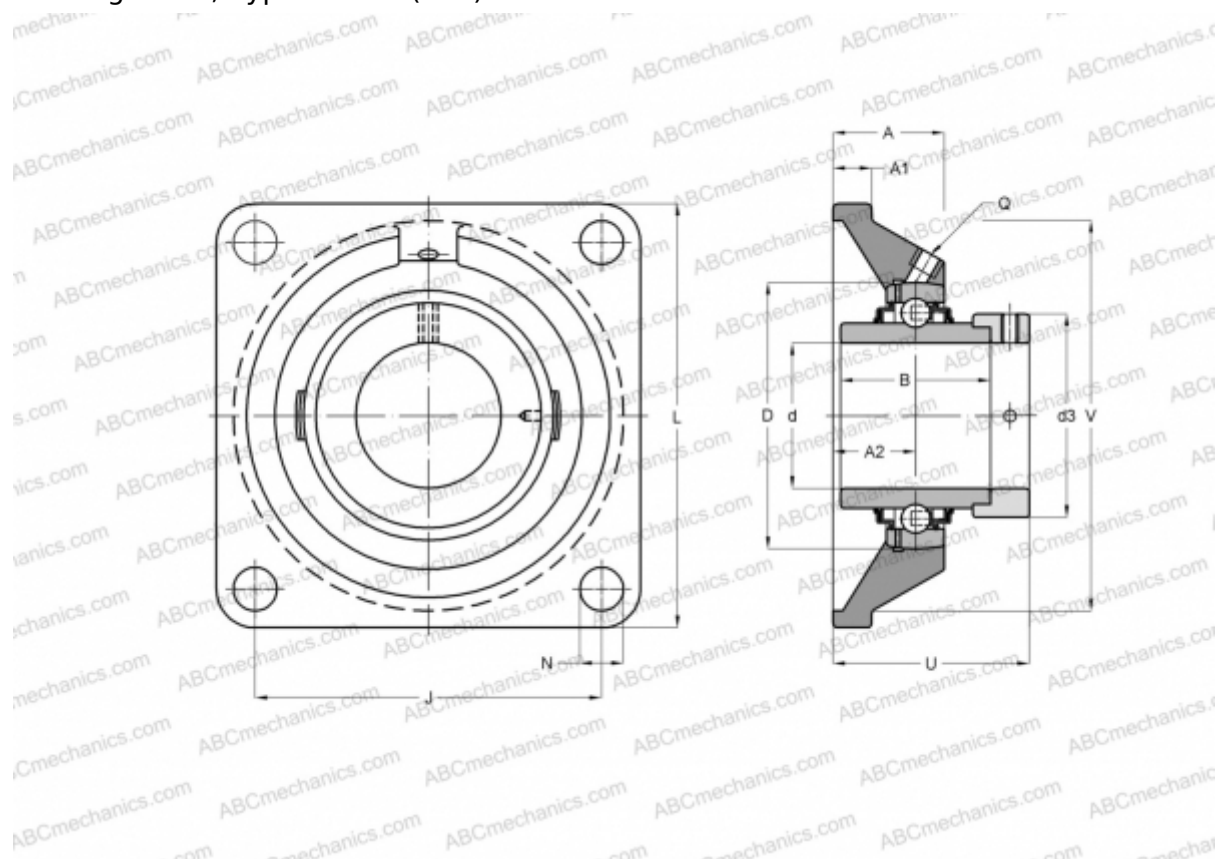

FY 30 WF SKF

Ball bearing units

TYPE: Housing units, Four-bolt flanged housing units, Cast iron housing, Radial insert ball bearing with eccentric locking collar, Type FY..WF (SKF)



Technical specification

DIMENSIONS, MM

d	30,000
D	62,000
B	48,400
L	108,000
A	32,500
J	82,500
A1	13,000
A2	20,000
N	11,500
d3	44,100
U	50,100
V	93,700

WEIGHT, KG 1,200

Bearing	YEL 206-2F
Housing	FY 506 M
Protective cover	ECY 206

MANUFACTURER

[SKF](#)

CALCULATION DATA

Basic dynamic load rating, C	19,500 kN
Basic static load rating, Co	11,200 kN
Fatigue load limit, Pu	0,475 kN
Limiting speed	6300 r/min