

## FY 60 WF SKF

Ball bearing units

TYPE: Housing units, Four-bolt flanged housing units, Cast iron housing, Radial insert ball bearing with eccentric locking collar, Type FY..WF (SKF)

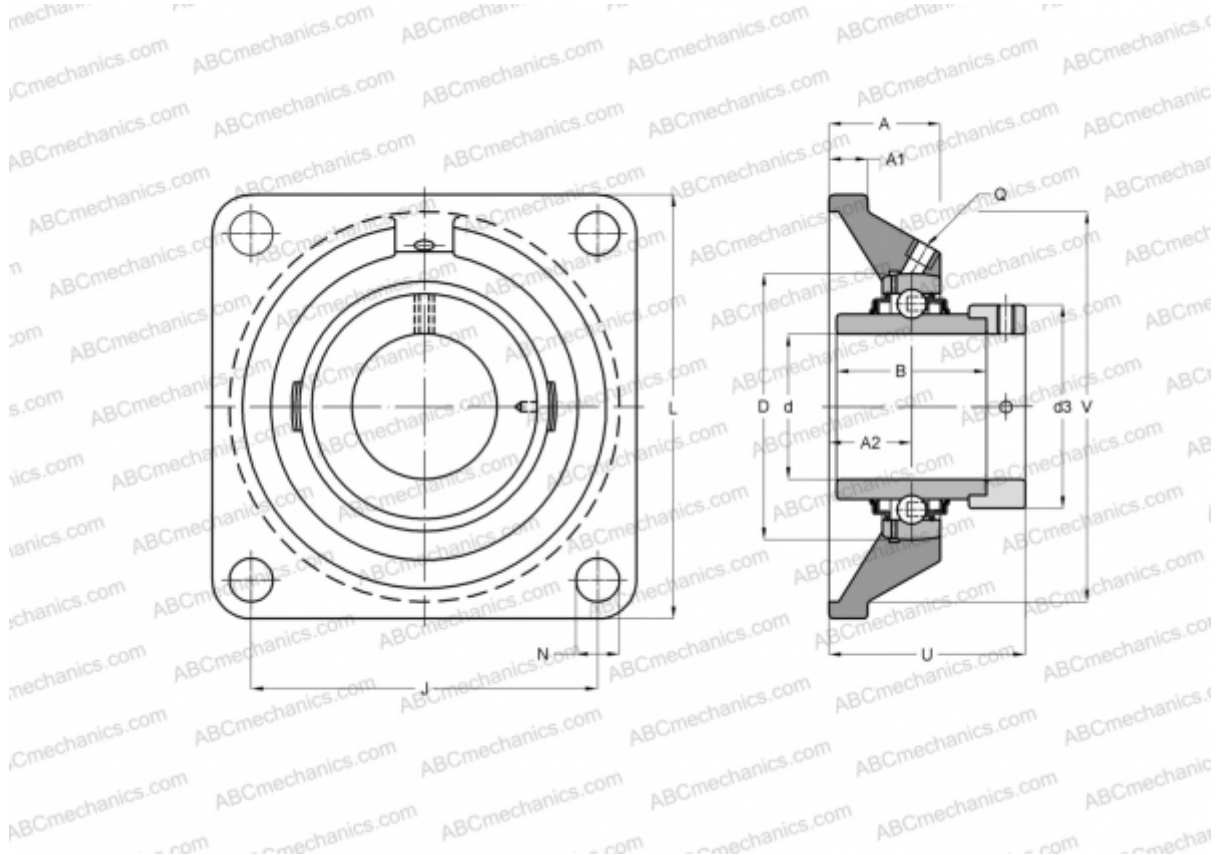

### Technical specification

#### DIMENSIONS, MM

d	60,000
D	110,000
B	77,800
L	175,000
A	52,000
J	143,000
A1	17,000
A2	34,000
N	18,000
d3	82,000
U	80,800
V	161,900

**WEIGHT, KG** 5,000

Bearing	YEL 212-2F
Housing	FY 512 M
Protective cover	ECY 212

#### MANUFACTURER

[SKF](#)

#### CALCULATION DATA

Basic dynamic load rating, C	52,700 kN
Basic static load rating, Co	36,000 kN
Fatigue load limit, Pu	1,530 kN
Limiting speed	3400 r/min