

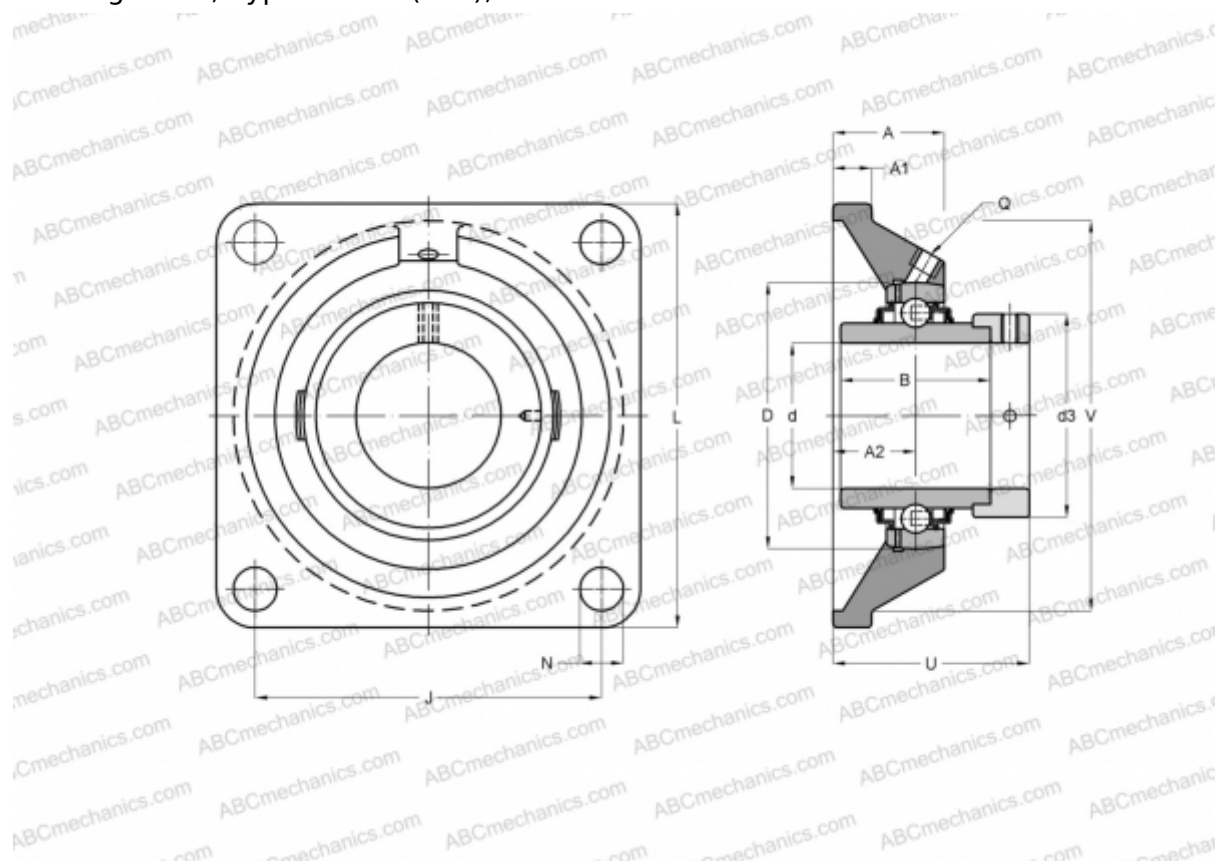

FY 2.7/16 WF SKF

Ball bearing units

TYPE: Housing units, Four-bolt flanged housing units, Cast iron housing, Radial insert ball bearing with eccentric locking collar, Type FY..WF (SKF), inch



Technical specification

DIMENSIONS, MM

d	61,913
D	100,000
B	77,800
L	175,000
A	52,000
J	143,000
A1	17,000
A2	34,000
d3	74,500
U	80,800

WEIGHT, KG 5,050

Bearing	YEL 212-207-2F
Housing	FY 512 U

MANUFACTURER

[SKF](#)

CALCULATION DATA

Basic dynamic load rating, C	52,700 kN
Basic static load rating, Co	36,000 kN
Fatigue load limit, Pu	1,530 kN
Limiting speed	3400 r/min