

## FYTJ 45 TF SKF

Ball bearing units

TYPE: Housing units, Two-bolt flanged housing units, Cast iron housing, Radial insert ball bearing with grub screws in inner ring, Type FYTB/FYTJ..TF (SKF)

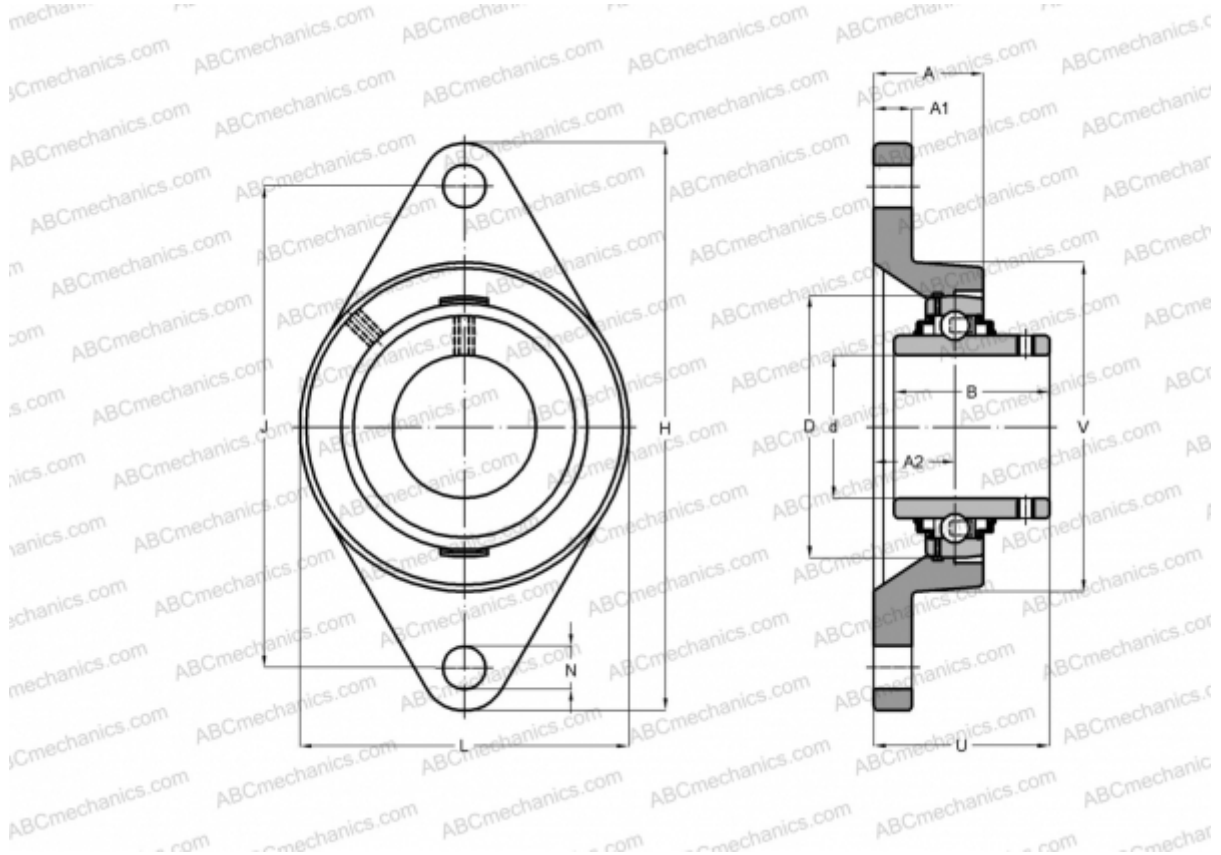

### Technical specification

#### DIMENSIONS, MM

d	45,000
D	85,000
B	49,200
L	108,000
H	188,000
A	38,000
J	148,000
A1	18,000
A2	22,000
N	19,000
U	52,200
V	98,400

#### WEIGHT, KG

2,200

Bearing	YAR 209-2F
Housing	FYTJ 509

#### MANUFACTURER

[SKF](#)

#### CALCULATION DATA

Basic dynamic load rating, C	33,200 kN
Basic static load rating, Co	21,600 kN
Fatigue load limit, Pu	0,915 kN
Limiting speed	4300 r/min