

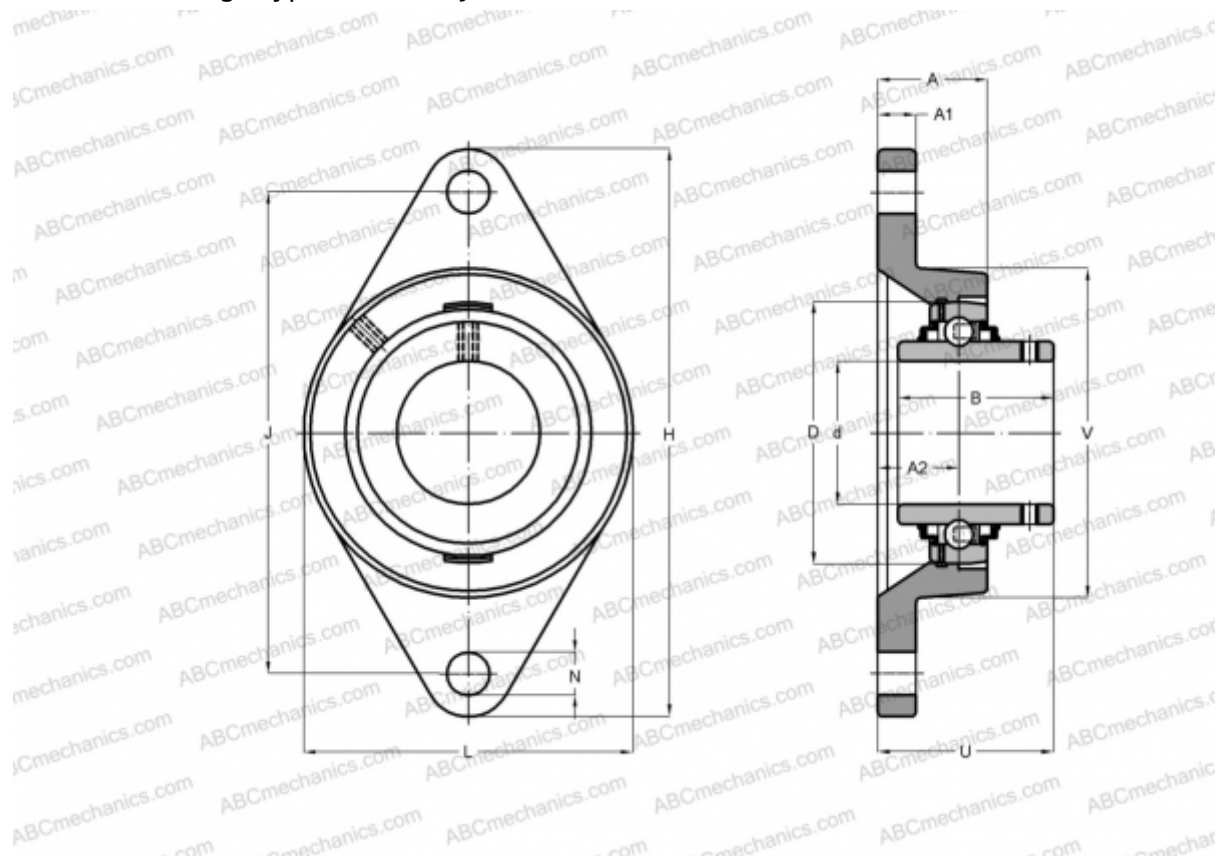

## FYTJ 50 TF SKF

Ball bearing units

TYPE: Housing units, Two-bolt flanged housing units, Cast iron housing, Radial insert ball bearing with grub screws in inner ring, Type FYTB/FYTJ..TF (SKF)



### Technical specification

#### DIMENSIONS, MM

d	50,000
D	90,000
B	51,600
L	115,000
H	195,000
A	40,000
J	157,000
A1	18,000
A2	22,000
N	19,000
U	54,600
V	101,600

**WEIGHT, KG** 3,100

Bearing	YAR 210-2F
Housing	FYTJ 510

#### MANUFACTURER

[SKF](#)

#### CALCULATION DATA

Basic dynamic load rating, C	35,100 kN
Basic static load rating, Co	23,200 kN
Fatigue load limit, Pu	0,980 kN
Limiting speed	4000 r/min

