

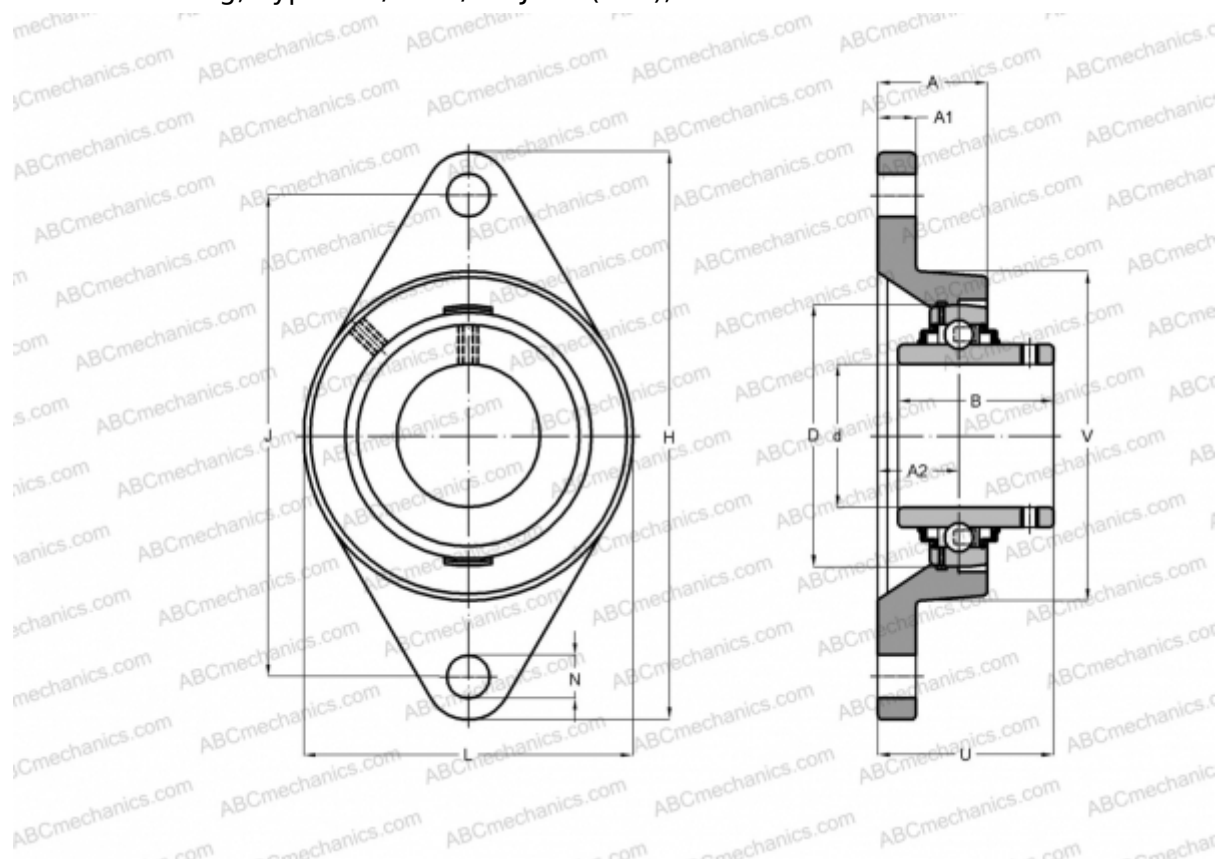

FYTB 3/4 TF SKF

Ball bearing units

TYPE: Housing units, Two-bolt flanged housing units, Cast iron housing, Radial insert ball bearing with grub screws in inner ring, Type FYT/FYTB/FYTJ..TF (SKF), inch



Technical specification

DIMENSIONS, MM

| | |
|----|---------|
| d | 19,050 |
| D | 47,000 |
| B | 31,000 |
| L | 60,500 |
| H | 112,000 |
| A | 29,500 |
| J | 90,000 |
| A1 | 11,000 |
| A2 | 19,000 |
| N | 11,500 |
| U | 37,300 |

WEIGHT, KG

0,500

Bearing

YAR 204-012-
2F

Housing

FYTB 504 M

MANUFACTURER

[SKF](#)

CALCULATION DATA

| | |
|------------------------------|------------|
| Basic dynamic load rating, C | 12,700 kN |
| Basic static load rating, Co | 6,550 kN |
| Fatigue load limit, Pu | 0,280 kN |
| Limiting speed | 8500 r/min |