

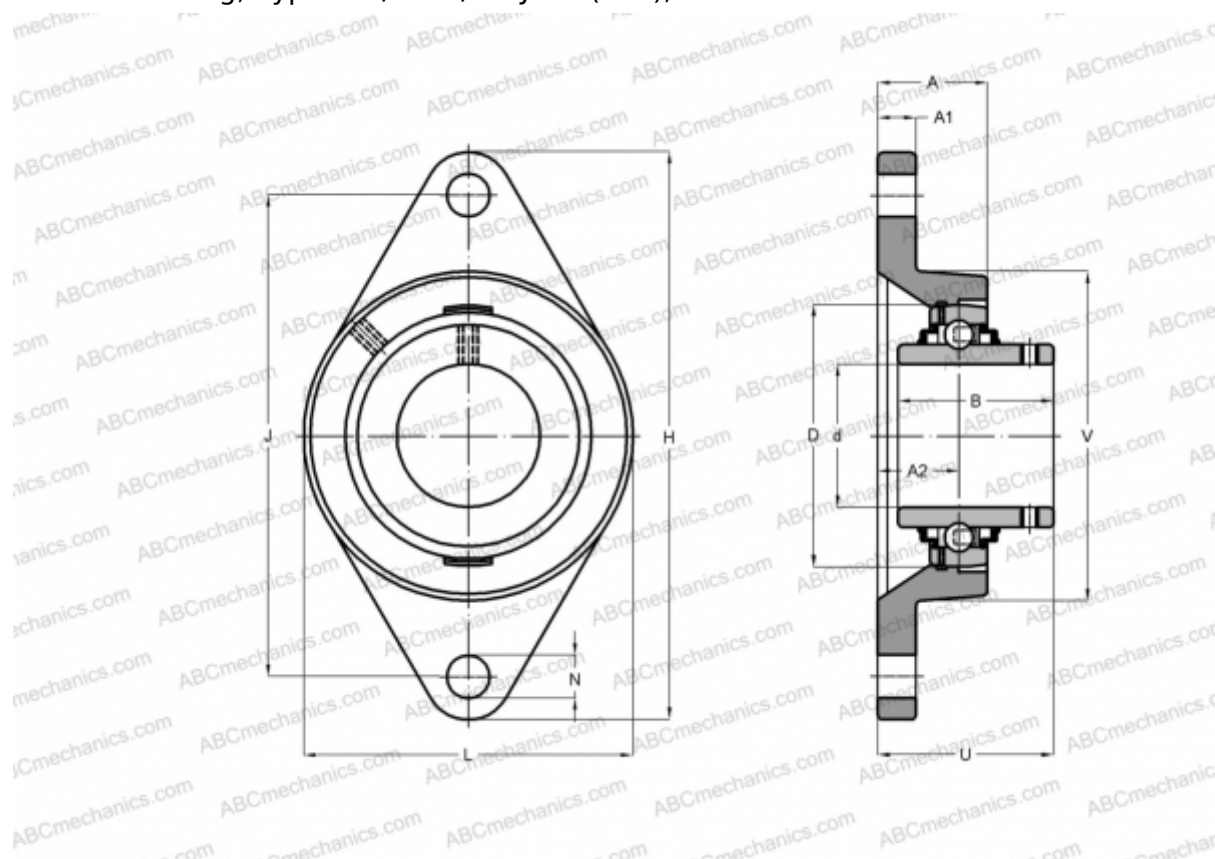

FYT 15/16 TF SKF

Ball bearing units

TYPE: Housing units, Two-bolt flanged housing units, Cast iron housing, Radial insert ball bearing with grub screws in inner ring, Type FYT/FYTB/FYTJ..TF (SKF), inch



Technical specification

DIMENSIONS, MM

| | |
|----|---------|
| d | 23,813 |
| D | 52,000 |
| B | 34,100 |
| L | 70,000 |
| H | 124,000 |
| A | 30,000 |
| J | 98,800 |
| A1 | 12,000 |
| A2 | 19,000 |
| N | 12,700 |
| U | 38,800 |

WEIGHT, KG

0,640

Bearing

YAR 205-015-
2F

Housing

FYT 505 U

MANUFACTURER

[SKF](#)

CALCULATION DATA

| | |
|------------------------------|------------|
| Basic dynamic load rating, C | 14,000 kN |
| Basic static load rating, Co | 7,800 kN |
| Fatigue load limit, Pu | 0,335 kN |
| Limiting speed | 7000 r/min |