

FYT 1.15/16 RM SKF

Ball bearing units

TYPE: Housing units, Two-bolt flanged housing units, Cast iron housing, Radial insert ball bearing with grub screws in inner ring, Type FYT..RM (SKF), inch

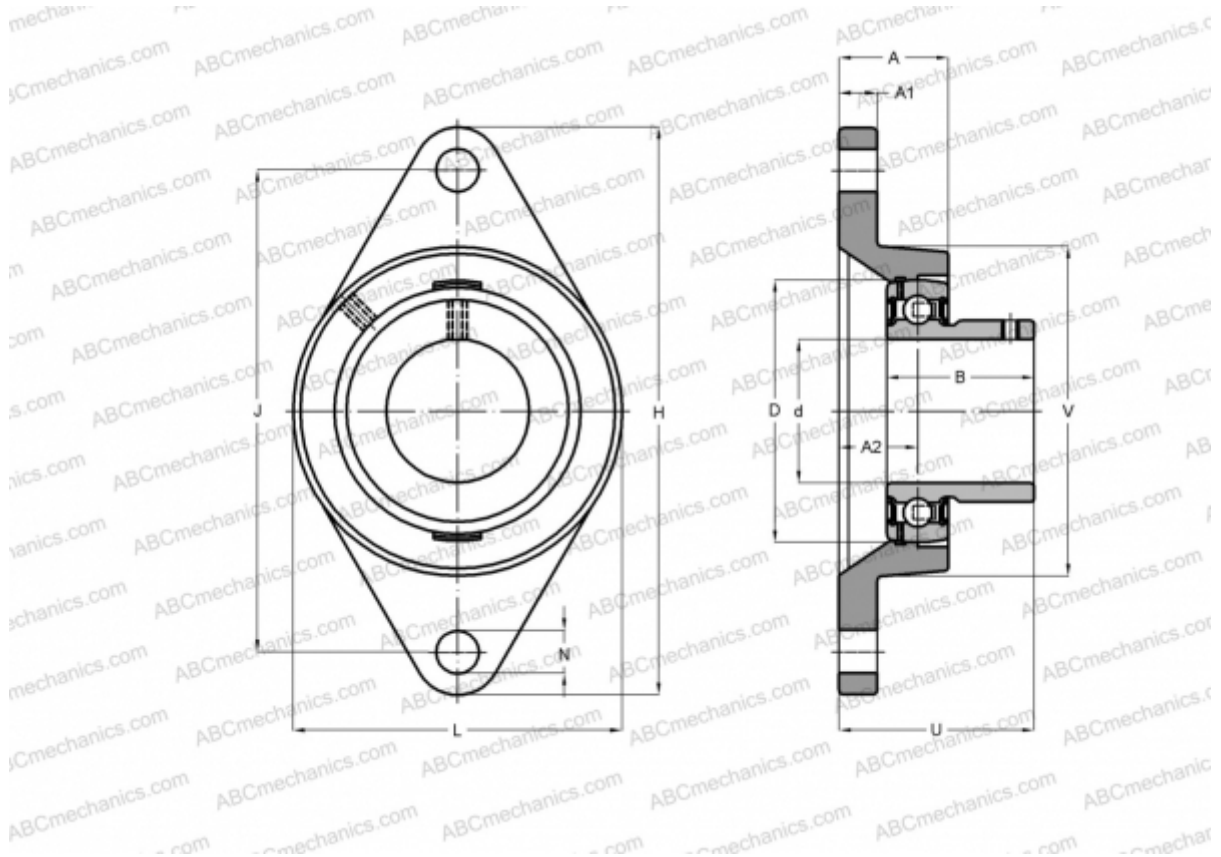

Technical specification

DIMENSIONS, MM

d	49,213
D	90,000
B	43,000
L	116,000
H	189,000
A	43,000
J	157,200
A1	15,000
A2	28,100
N	15,900
U	60,100

WEIGHT, KG

2,100

Bearing

YAT 210-115

Housing

FYT 510 U

MANUFACTURER

[SKF](#)

CALCULATION DATA

Basic dynamic load rating, C	35,100 kN
Basic static load rating, Co	23,200 kN
Fatigue load limit, Pu	0,980 kN
Limiting speed	4000 r/min