

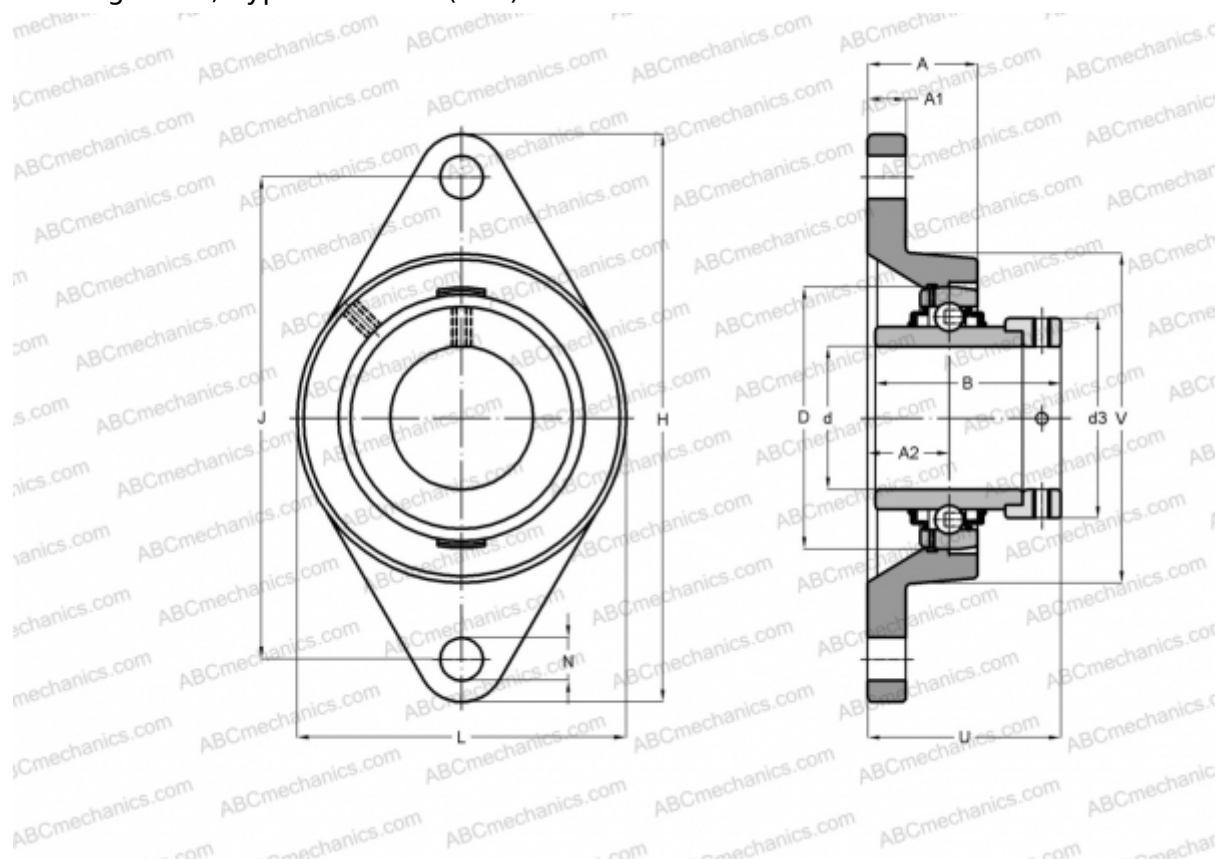

FYTB 35 WF SKF

Ball bearing units

TYPE: Housing units, Two-bolt flanged housing units, Cast iron housing, Radial insert ball bearing with eccentric locking collar, Type FYTB..WF (SKF)



Technical specification

DIMENSIONS, MM

d	35,000
D	72,000
B	51,100
L	96,000
H	156,000
A	34,500
J	130,000
A1	13,000
A2	32,300
N	14,000
d3	51,100
U	53,300
V	88,900

WEIGHT, KG 1,400

Bearing	YEL 207-2F
Housing	FYTB 507 M
Protective cover	ECY 207

MANUFACTURER

[SKF](#)

CALCULATION DATA

Basic dynamic load rating, C	25,500 kN
Basic static load rating, Co	15,300 kN
Fatigue load limit, Pu	0,655 kN
Limiting speed	5300 r/min

