

## TU 40 TF SKF

Ball bearing units

TYPE: Housing units, Take-up housing units, Cast iron housing, Radial insert ball bearing with grub screws in inner ring, Type TU/TUJ..TF (SKF)

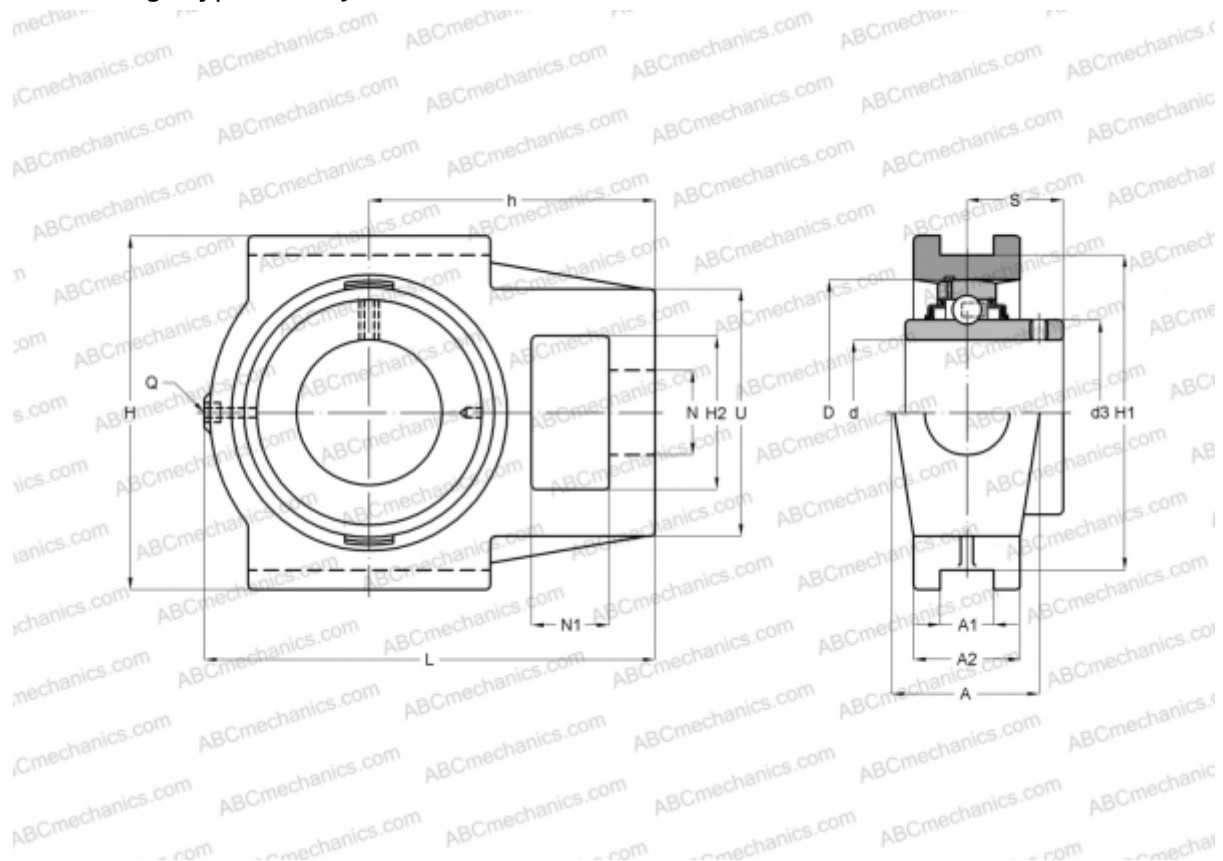

### Technical specification

#### DIMENSIONS, MM

d	40,000
D	80,000
B	49,200
L	145,000
H	115,000
A	49,000
H2	50,000
A1	17,500
A2	33,000
H1	101,000
N	29,000
N1	19,000
S	30,200
U	83,000
h	88,000

#### WEIGHT, KG

	2,300
Bearing	YAR 208-2F
Housing	TU 508 M
Protective cover	ECY 208

#### MANUFACTURER

[SKF](#)

#### CALCULATION DATA

Basic dynamic load rating, C	30,700 kN
Basic static load rating, Co	19,000 kN
Fatigue load limit, Pu	0,800 kN
Limiting speed	4800 r/min