

## SY 1.3/4 TF/VA201 SKF

Ball bearing units

TYPE: Housing units, Plummer block, Cast iron housing, Radial insert ball bearing with grub screws in inner ring, Type SY..TF/VA201, high temperature, inch (-40°/+250°) (SKF)

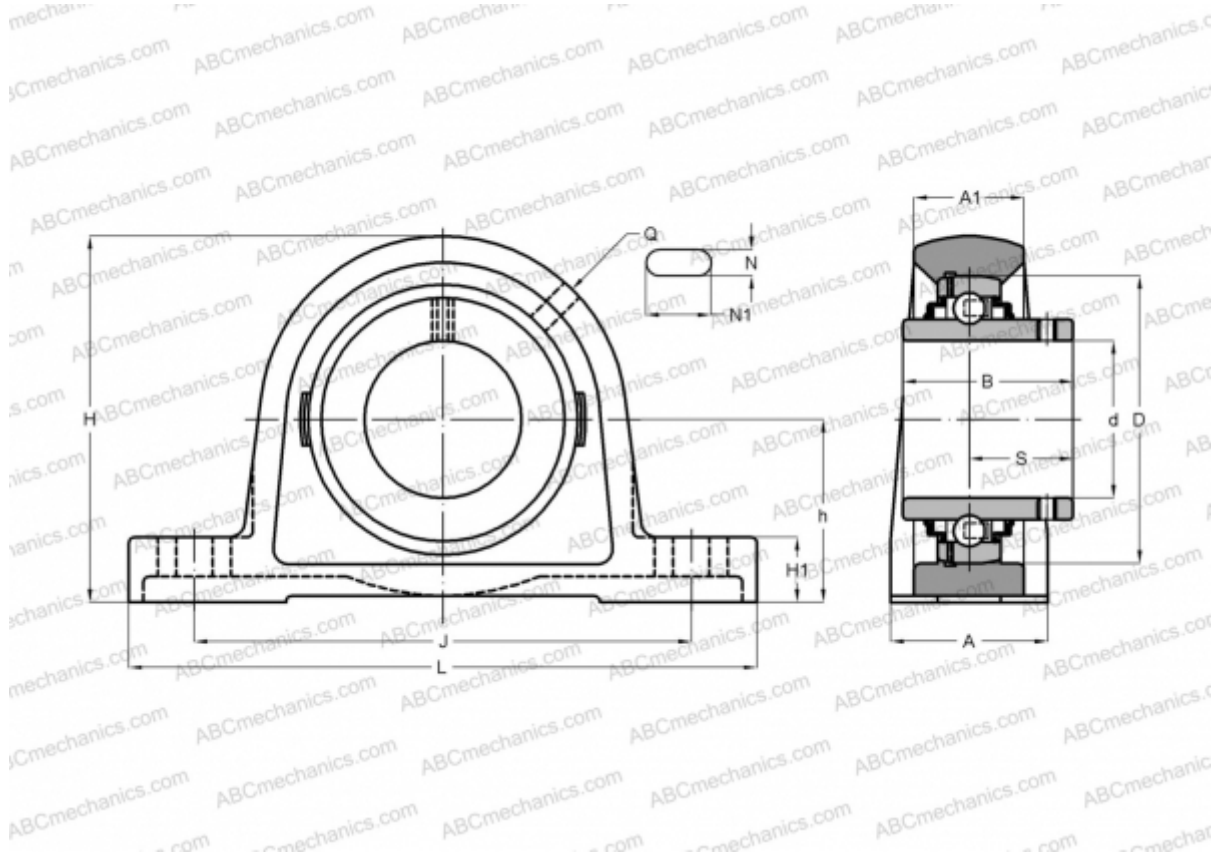

### Technical specification

#### DIMENSIONS, MM

d	44,450
D	85,000
B	49,200
L	187,000
H	107,000
A	48,000
J	143,500
H1	20,600
N	14,500
N1	22,500
h	54,000

#### WEIGHT, KG

2,200

Bearing

YAR 209-112  
2F/VA201

Housing

SY 509

#### MANUFACTURER

U/VA228  
[SKF](#)

#### CALCULATION DATA

Basic dynamic load rating, C	33,200 kN
Basic static load rating, Co	21,600 kN
Limiting speed	60 r/min
Operating temperature max	250 °C