

FY 1.1/2 TF/VA201 SKF

Ball bearing units

TYPE: Housing units, Four-bolt flanged housing units, Cast iron housing, Radial insert ball bearing with grub screws in inner ring, Type FY..TF/VA201, high temperature, inch size (-40°/+250°) (SKF)

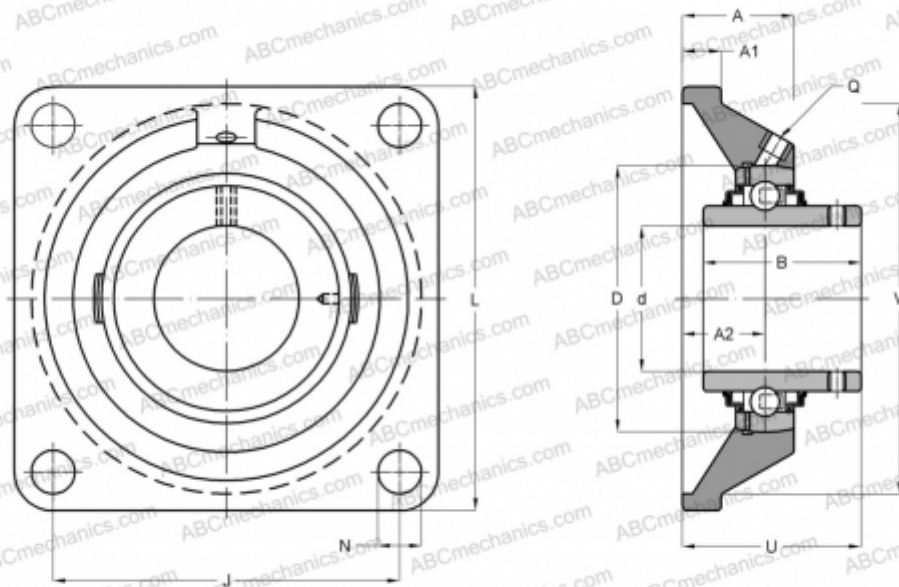

Technical specification

DIMENSIONS, MM

d	38,100
D	80,000
B	49,200
L	130,000
A	38,500
J	101,500
A1	14,000
N	14,300
U	54,200

WEIGHT, KG

1,900

Bearing	YAR 208-108-
Housing	FY 508 U/VA228

MANUFACTURER

[SKF](#)

CALCULATION DATA

Basic dynamic load rating, C	30,700 kN
Basic static load rating, Co	19,000 kN
Limiting speed	70 r/min
Operating temperature max	250 °C