

FYT 25 TF/VA201 SKF

Ball bearing units

TYPE: Housing units, Two-bolt flanged housing units, Cast iron housing, Radial insert ball bearing with grub screws in inner ring, Type FYT..TF/VA201, high temperature (-40°/+250°) (SKF)

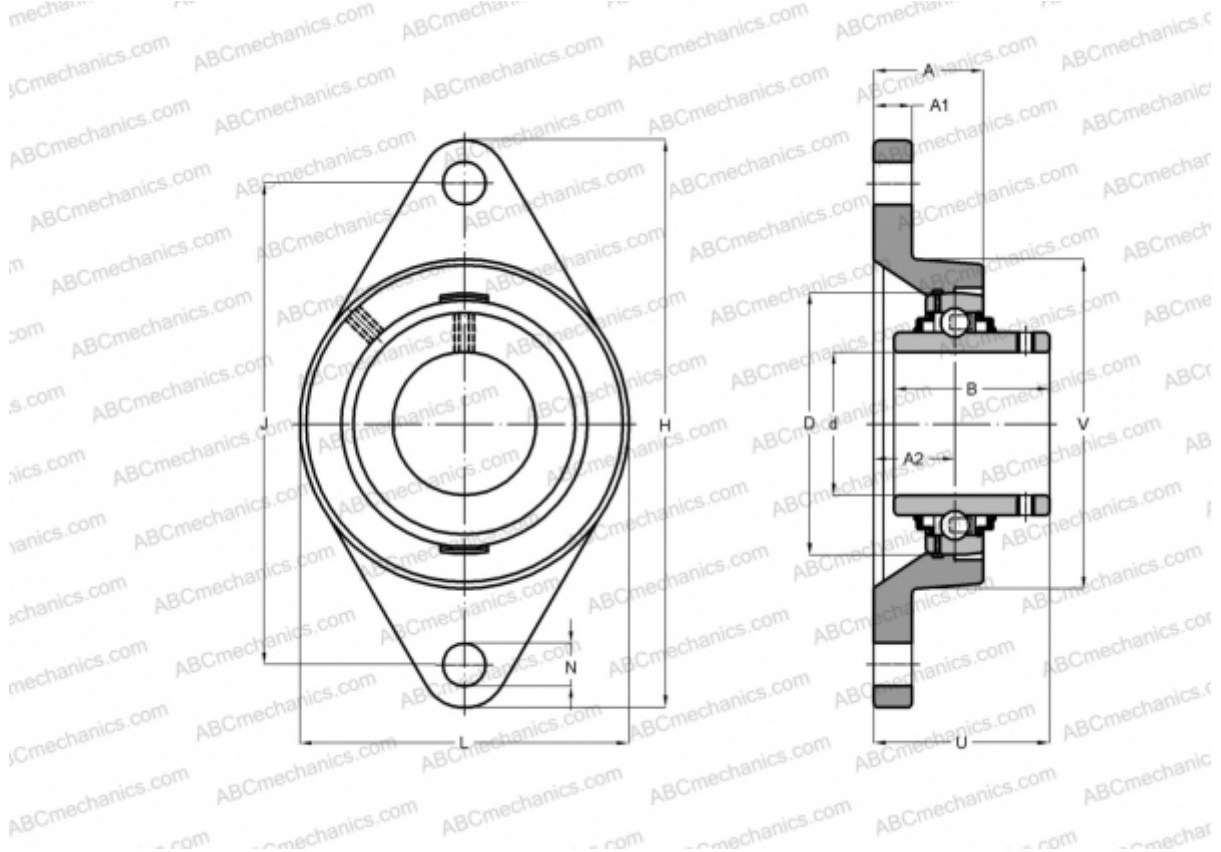

Technical specification

DIMENSIONS, MM

d	25,000
D	52,000
B	34,100
L	70,000
H	124,000
A	30,000
J	98,900
A1	12,000
A2	14,300
N	12,700
U	38,800

WEIGHT, KG

0,630

Bearing

YAR 205-
2F/VA201

Housing

FYT 505

MANUFACTURER

U/VA228

[SKF](#)

CALCULATION DATA

Basic dynamic load rating, C	14,000 kN
Basic static load rating, Co	7,800 kN
Limiting speed	110 r/min
Operating temperature max	250 °C