

FYT 30 TF/VA201 SKF

Ball bearing units

TYPE: Housing units, Two-bolt flanged housing units, Cast iron housing, Radial insert ball bearing with grub screws in inner ring, Type FYT..TF/VA201, high temperature (-40°/+250°) (SKF)

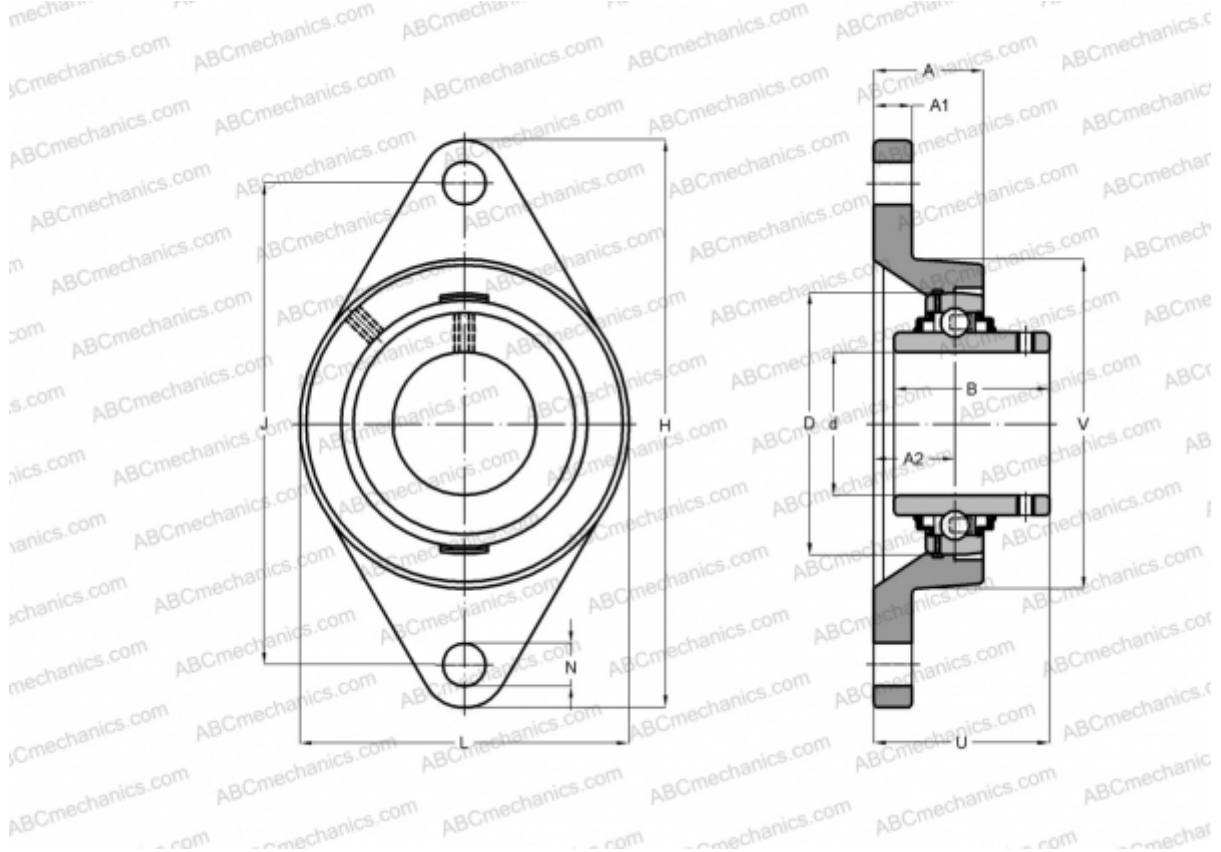

Technical specification

DIMENSIONS, MM

d	30,000
D	62,000
B	38,100
L	83,000
H	141,500
A	32,700
J	116,700
A1	13,000
A2	15,900
N	12,700
U	42,200

WEIGHT, KG

0,930

Bearing

YAR 206-
2F/VA201

Housing

FYT 506

MANUFACTURER

U/VA228
[SKF](#)

CALCULATION DATA

Basic dynamic load rating, C	19,500 kN
Basic static load rating, Co	11,200 kN
Limiting speed	90 r/min
Operating temperature max	250 °C