

FYT 20 TF/VA228 SKF

Ball bearing units

TYPE: Housing units, Two-bolt flanged housing units, Cast iron housing, Radial insert ball bearing with grub screws in inner ring, Type FYT..TF/VA228, high temperature, for high demands (-150°/+350°) (SKF)

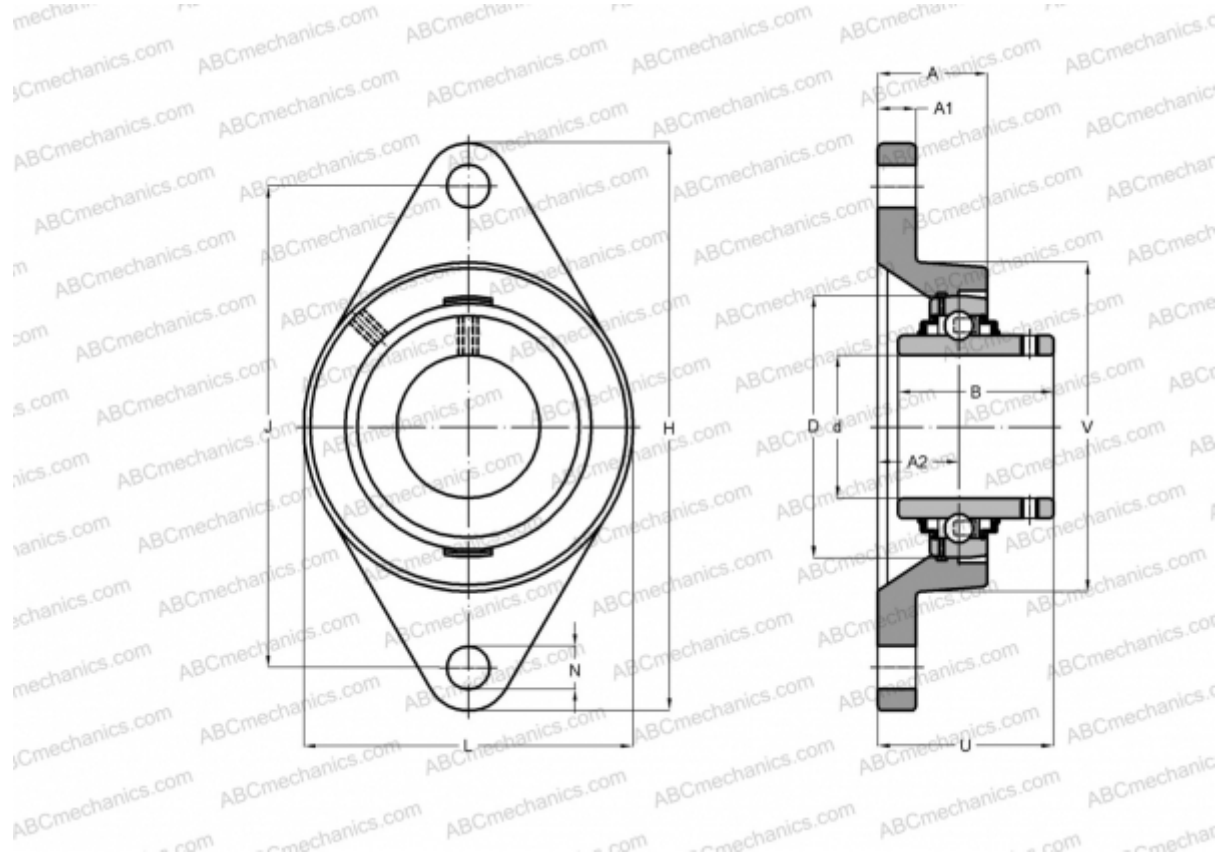

Technical specification

DIMENSIONS, MM

d	20,000
D	47,000
B	31,000
L	60,500
H	112,000
A	29,610
J	89,700
A1	11,000
A2	12,700
N	11,100
U	32,600

WEIGHT, KG

0,500

Bearing

YAR 204-
2F/VA228

Housing

FYT 504

MANUFACTURER

U/VA228
[SKF](#)

CALCULATION DATA

Basic dynamic load rating, C	12,700 kN
Basic static load rating, Co	6,550 kN
Limiting speed	260 r/min
Operating temperature max	350 °C