

# RASEY45 INA

Ball bearing units

TYPE: Housing units, Plummer block, Cast iron housing, Radial insert ball bearing with grub screws in inner ring, Type RASEY (INA)

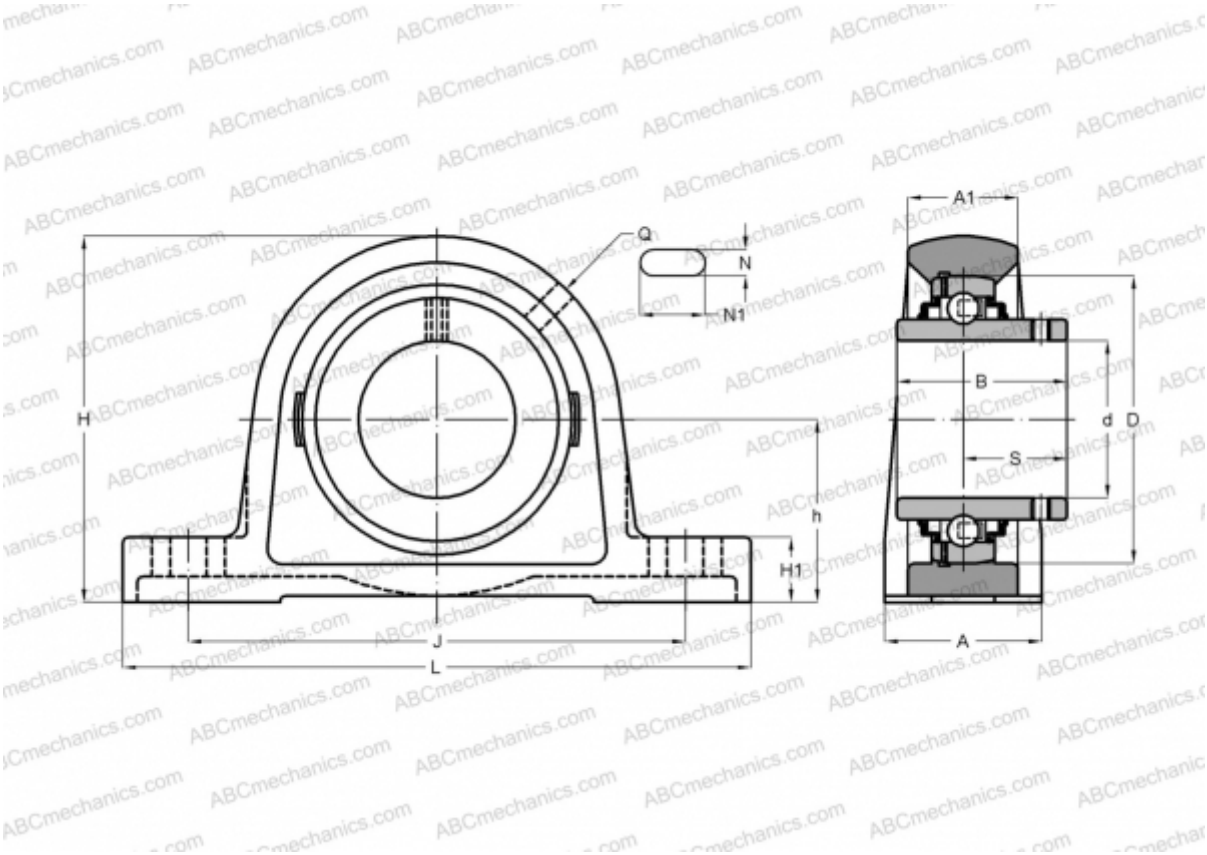

## Technical specification

### DIMENSIONS, MM

d	45,000
D	85,000
B	49,200
L	192,000
H	107,000
A	48,000
J	150,000
A1	32,000
H1	21,500
N	14,000
N1	29,000
S	30,200
h	54,000
Q	Rp1/8

### WEIGHT, KG

	2,160
Bearing	GYE45-KRR-B
Housing	GG.ASE09

### MANUFACTURER

[INA](#)

### CALCULATION DATA

Basic dynamic load rating, C	32,500 kN
Basic static load rating, Co	20,400 kN