

## RASEY80 INA

Ball bearing units

TYPE: Housing units, Plummer block, Cast iron housing, Radial insert ball bearing with grub screws in inner ring, Type RASEY (INA)

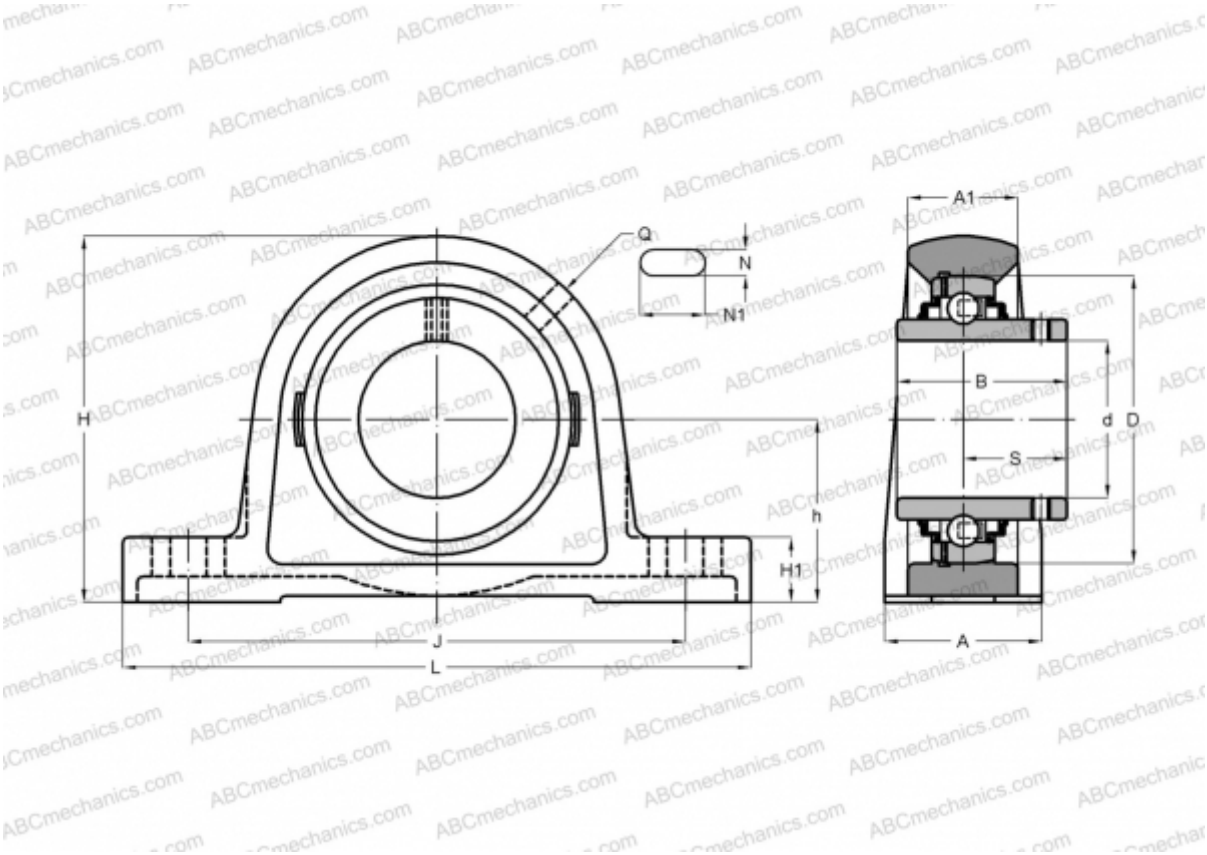

### Technical specification

#### DIMENSIONS, MM

d	80,000
D	140,000
B	82,600
L	290,000
H	175,000
A	78,000
J	232,000
A1	55,000
H1	30,000
N	26,000
N1	35,000
S	49,300
h	89,000
Q	Rp1/8

#### WEIGHT, KG

	8,410
Bearing	GYE80-KRR-B
Housing	GG.ASE16

#### MANUFACTURER

[INA](#)

#### CALCULATION DATA

Basic dynamic load rating, C	72,000 kN
Basic static load rating, Co	54,000 kN