

RASEY90 INA

Ball bearing units

TYPE: Housing units, Plummer block, Cast iron housing, Radial insert ball bearing with grub screws in inner ring, Type RASEY (INA)

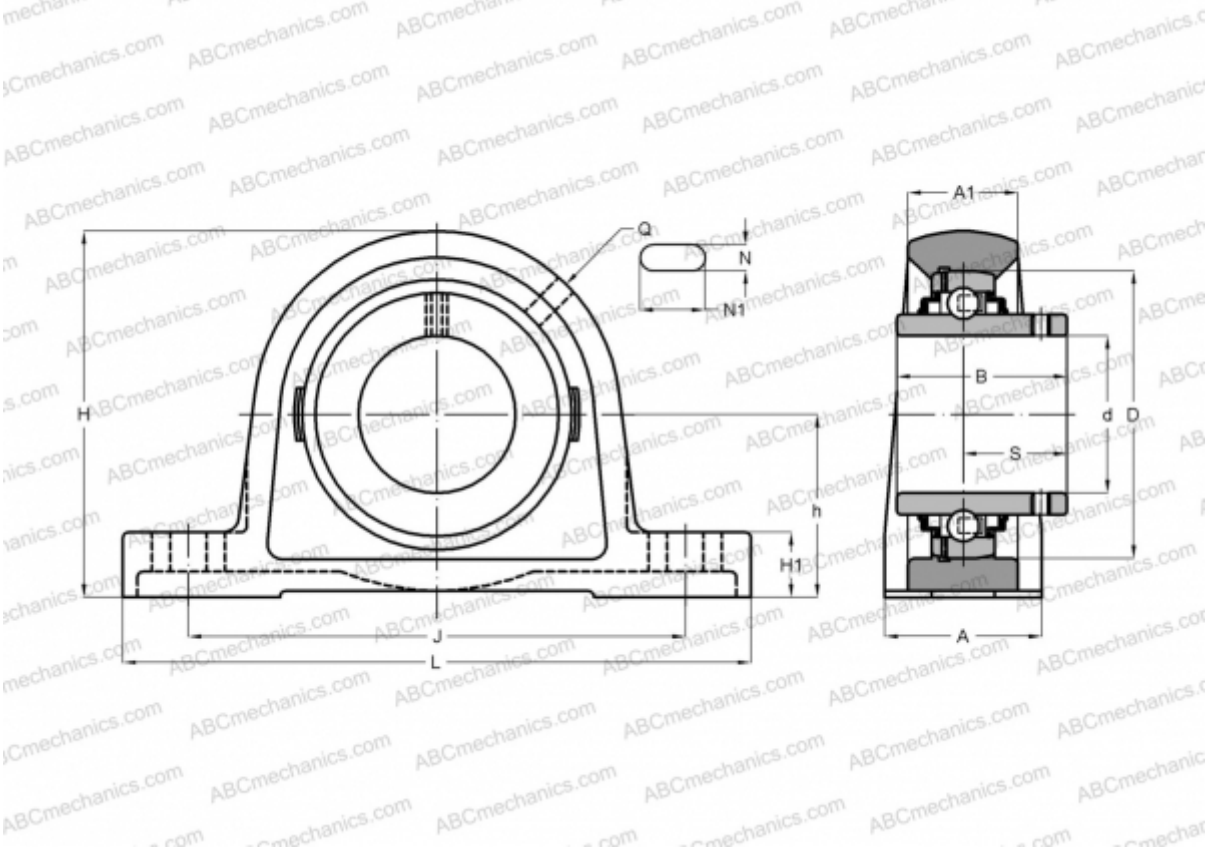

Technical specification

DIMENSIONS, MM		WEIGHT, KG	
d	90,000	12,600	
D	160,000	Bearing	GYE90-KRR-B
B	96,000	Housing	GG.ASE18
L	330,000	MANUFACTURER	
H	200,000	INA	
A	85,000	CALCULATION DATA	
J	268,000	Basic dynamic load rating, C	96,000 kN
A1	55,000	Basic static load rating, Co	72,000 kN
H1	35,000		
N	27,000		
N1	35,000		
S	56,300		
h	101,600		
Q	Rp1/8		