

## PSHE35-N INA

Ball bearing units

TYPE: Housing units, Plummer block, Narrow cast iron housing, Radial insert ball bearing with eccentric locking collar, Type PSHE (INA)

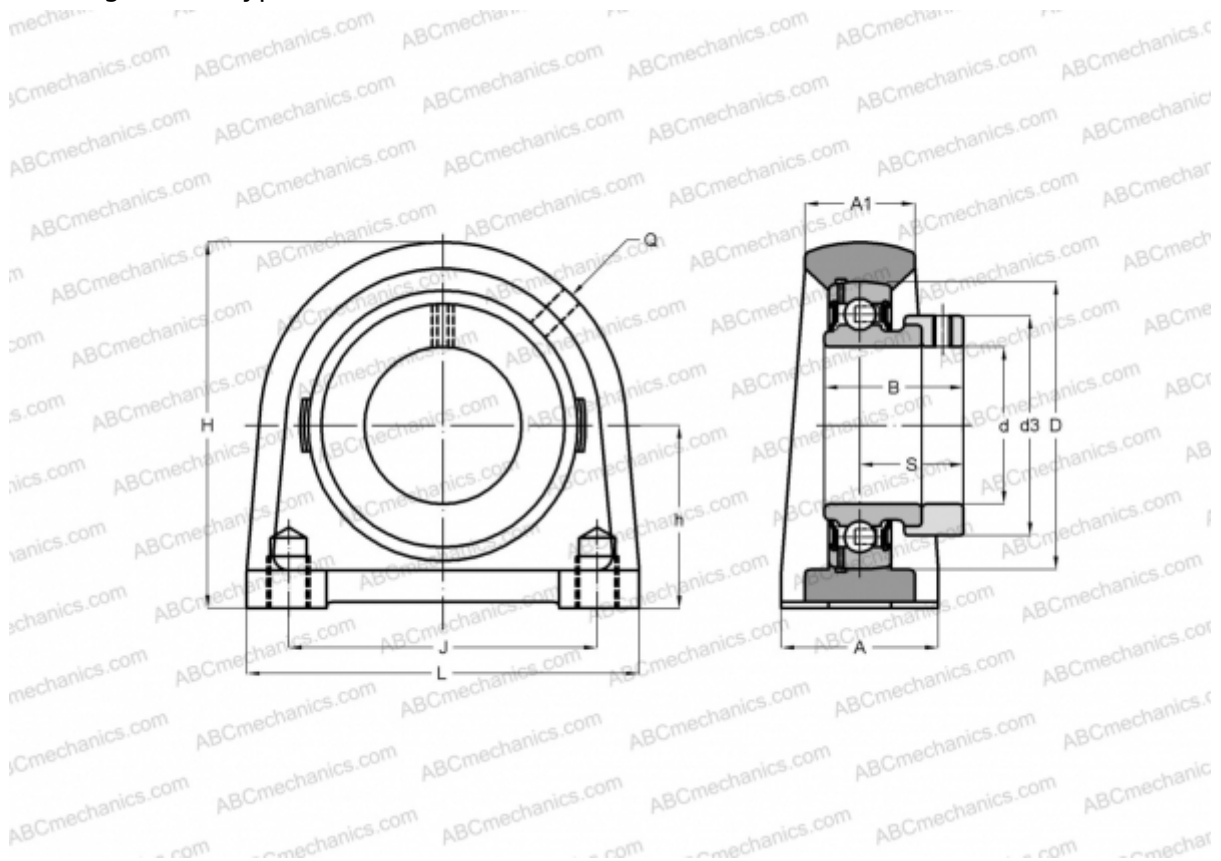

### Technical specification

#### DIMENSIONS, MM

d	35,000
D	72,000
B	39,000
L	103,000
H	93,000
A	45,000
J	82,600
A1	27,000
S	29,500
d3	51,000
h	47,600
Q	Rp1/8

#### WEIGHT, KG

1,260

Bearing	GRAE35-NPP-B
Housing	GG.SHE07-E-N
Protective cover	KASK07

#### MANUFACTURER

[INA](#)

#### CALCULATION DATA

Basic dynamic load rating, C	25,500 kN
Basic static load rating, Co	15,300 kN