

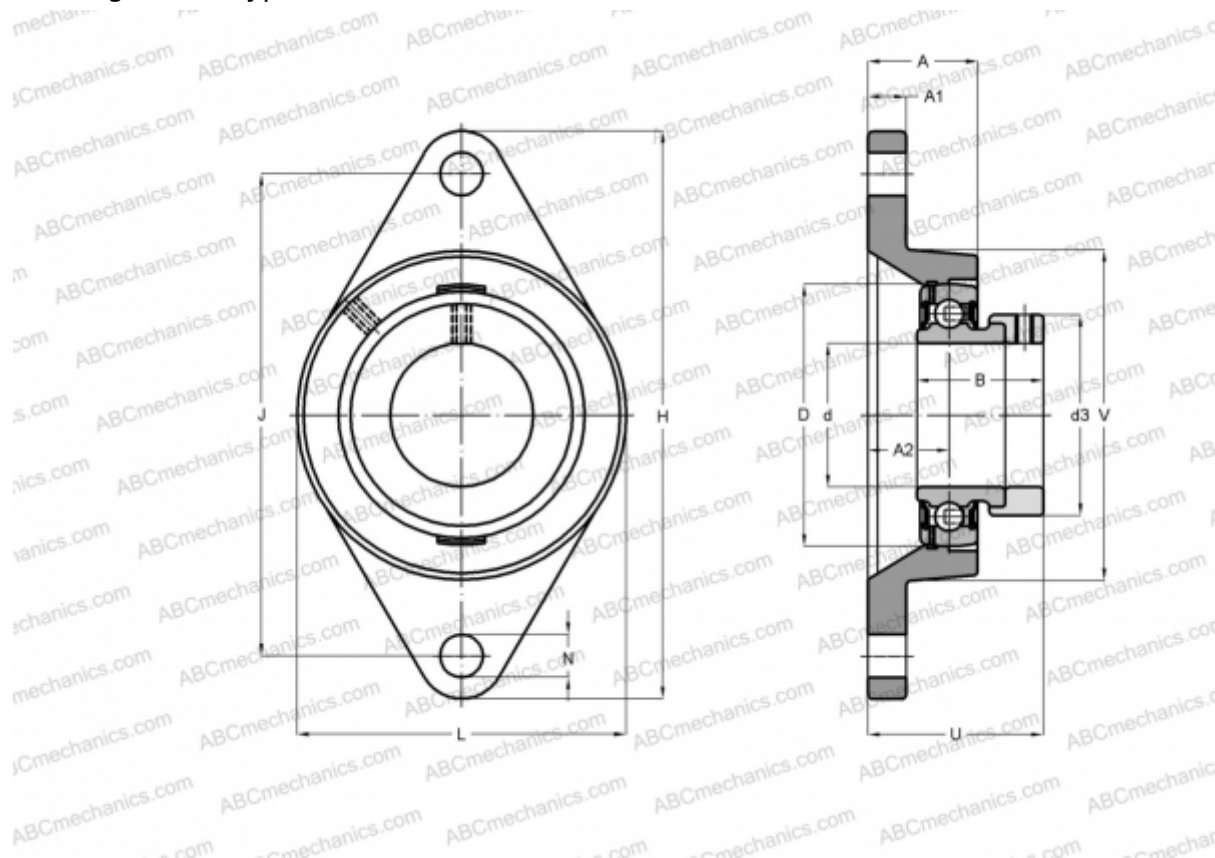

PCFT30 INA

Ball bearing units

TYPE: Housing units, Two-bolt flanged housing units, Cast iron housing, Radial insert ball bearing with eccentric locking collar, Type PCFT (INA)



Technical specification

DIMENSIONS, MM

d	30,000
D	62,000
B	35,800
L	80,000
H	142,000
A	22,300
J	116,500
A1	12,000
A2	13,300
N	11,500
d3	44,000
U	40,000
V	80,000
Q	Rp1/8

WEIGHT, KG

0,770

Bearing

GRAE30-NPP-B

Housing

GG.CFT06

MANUFACTURER

[INA](#)

CALCULATION DATA

Basic dynamic load rating, C	19,500 kN
Basic static load rating, Co	11,300 kN

