

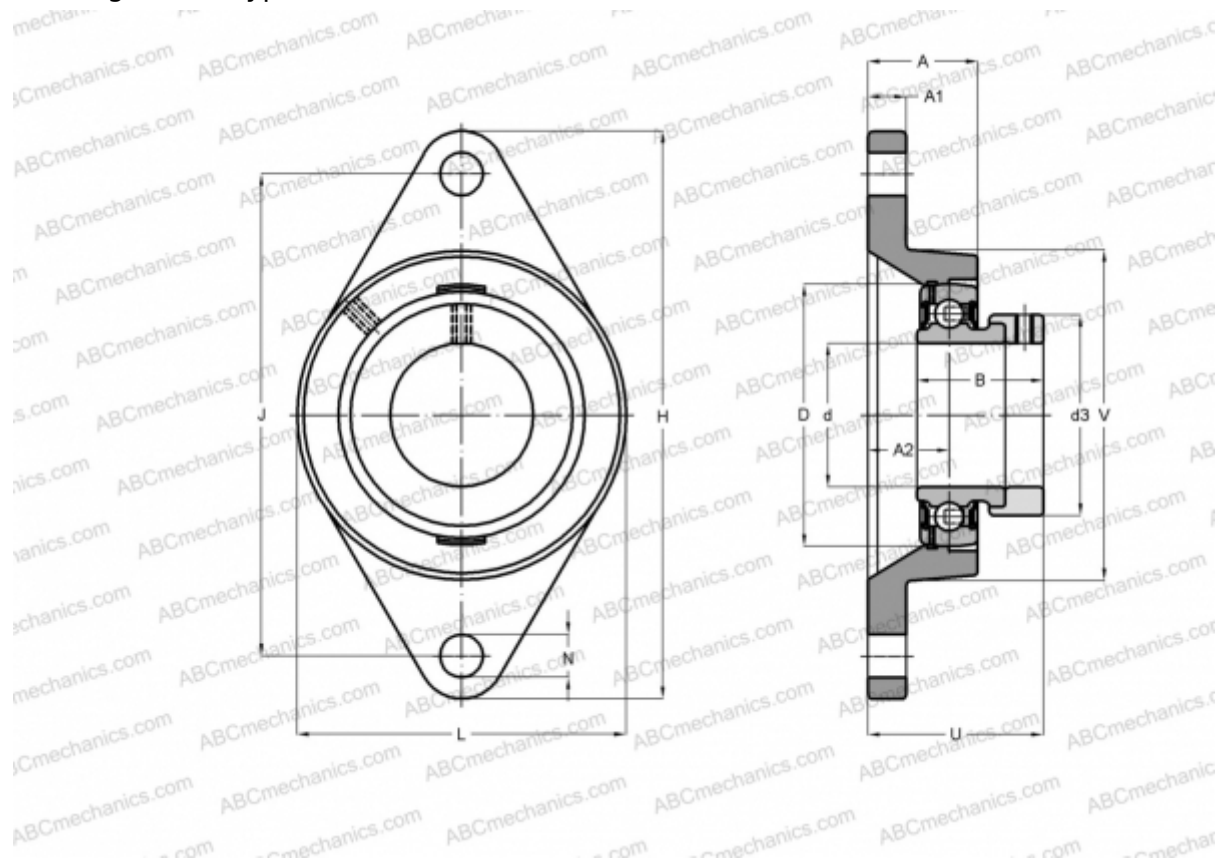

## PCFT40 INA

Ball bearing units

TYPE: Housing units, Two-bolt flanged housing units, Cast iron housing, Radial insert ball bearing with eccentric locking collar, Type PCFT (INA)



### Technical specification

#### DIMENSIONS, MM

d	40,000
D	80,000
B	43,800
L	105,000
H	172,000
A	28,800
J	143,500
A1	13,000
A2	18,300
N	14,000
d3	58,000
U	51,000
V	105,000
Q	Rp1/8

#### WEIGHT, KG

1,420

Bearing

GRAE40-NPP-B

Housing

GG.CFT08

#### MANUFACTURER

[INA](#)

#### CALCULATION DATA

Basic dynamic load rating, C	32,500 kN
Basic static load rating, Co	19,800 kN