

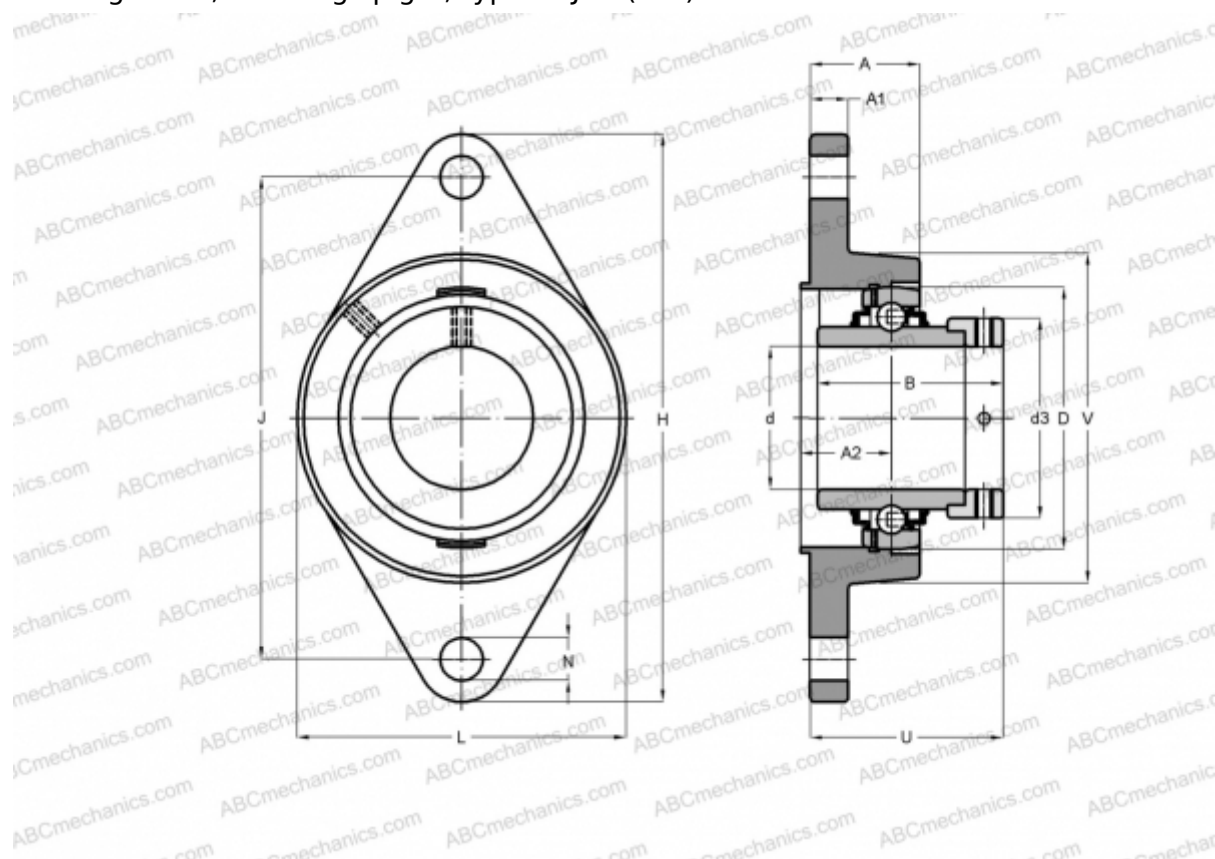

RCJTZ30 INA

Ball bearing units

TYPE: Housing units, Two-bolt flanged housing units, Cast iron housing, Radial insert ball bearing with eccentric locking collar, Centring spigot, type RCJTZ (INA)



Technical specification

DIMENSIONS, MM

d	30,000
D	62,000
B	48,500
L	83,000
H	142,000
A	26,000
J	48,500
A1	12,000
A2	17,000
N	11,500
d3	44,000
U	47,100
V	83,000
Q	Rp1/8

WEIGHT, KG

0,900

Bearing

GE30-KRR-B

Housing

GG.CJTZ06

MANUFACTURER

[INA](#)

CALCULATION DATA

Basic dynamic load rating, C	19,500 kN
Basic static load rating, Co	11,300 kN