

RCJTZ45 INA

Ball bearing units

TYPE: Housing units, Two-bolt flanged housing units, Cast iron housing, Radial insert ball bearing with eccentric locking collar, Centring spigot, type RCJTZ (INA)

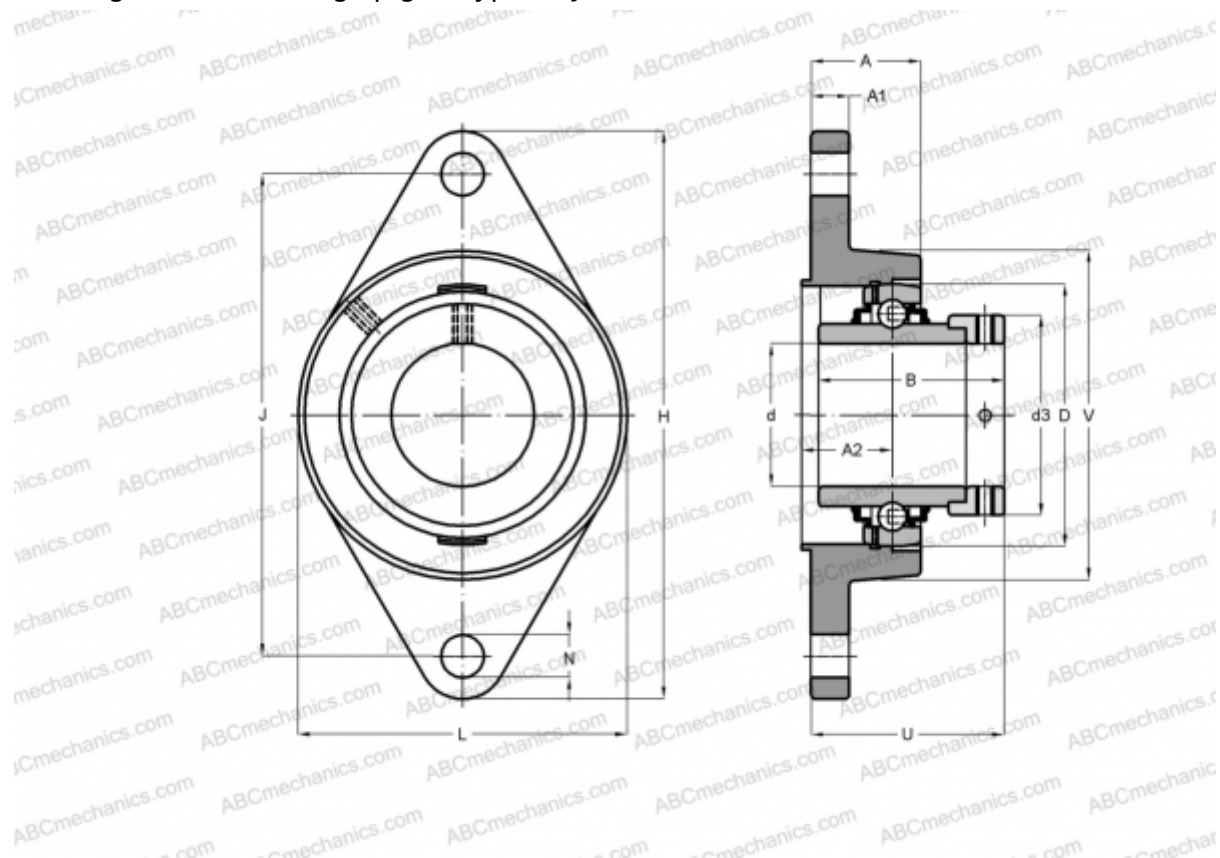

Technical specification

DIMENSIONS, MM

d	45,000
D	85,000
B	56,500
L	111,000
H	180,000
A	31,000
J	56,500
A1	13,000
A2	20,000
N	14,000
d3	63,000
U	54,900
V	111,000
Q	Rp1/8

WEIGHT, KG

1,860

Bearing	GE45-KRR-B
Housing	GG.CJTZ09

MANUFACTURER

[INA](#)

CALCULATION DATA

Basic dynamic load rating, C	32,500 kN
Basic static load rating, Co	20,400 kN