

RCJTY25-JIS INA

Ball bearing units

TYPE: Housing units, Two-bolt flanged housing units, Cast iron housing, Radial insert ball bearing with grub screws in inner ring, Type RCJTY (INA), dimensions sizes by standard JIS B 1559

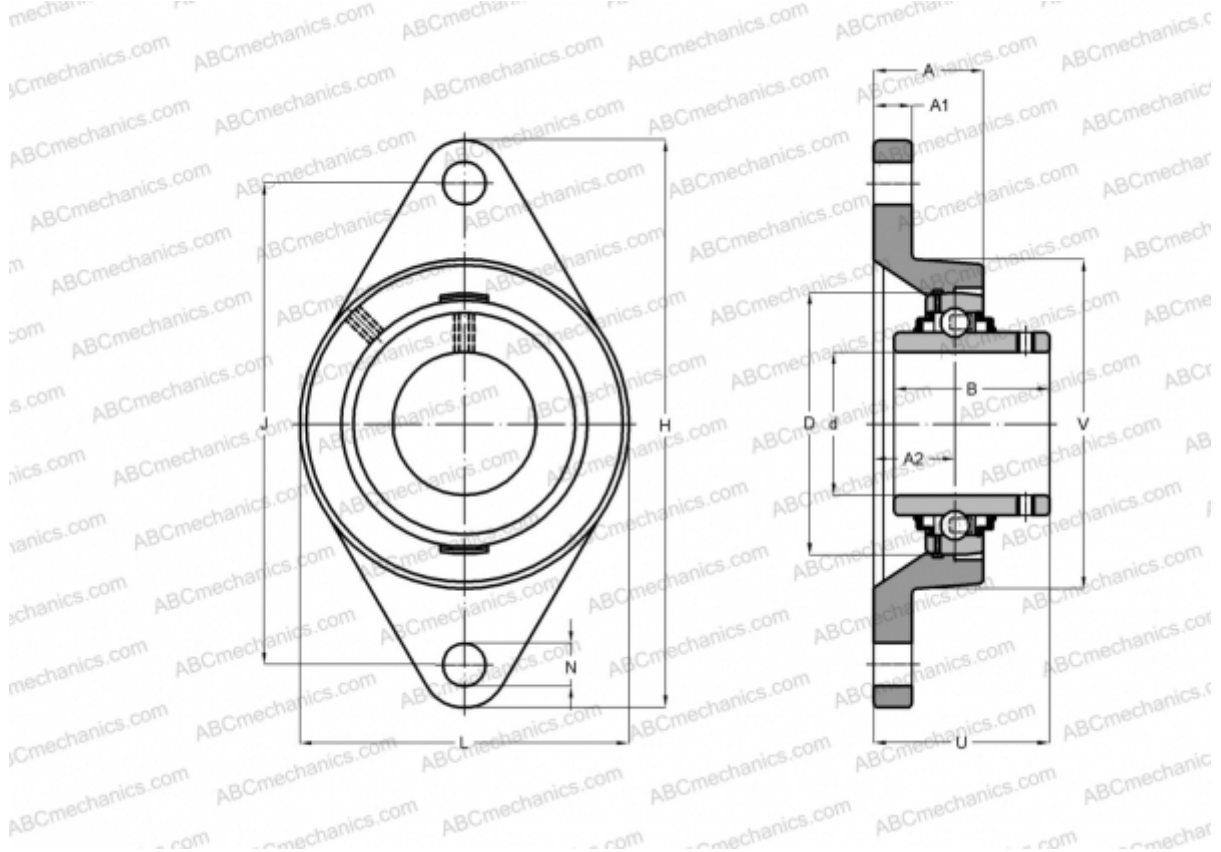

Technical specification

DIMENSIONS, MM

d	25,000
D	52,000
B	34,100
L	68,000
H	130,000
A	27,000
J	99,000
A1	14,000
A2	16,000
N	16,000
U	35,800
Q	M6

WEIGHT, KG 0,610

Bearing	GYE25-KRR-B-
Housing	GG.FL205

MANUFACTURER

[INA](#)

CALCULATION DATA

Basic dynamic load rating, C	14,000 kN
Basic static load rating, Co	7,800 kN